

# WFG M (3000 / 6000 PSI)

Adapter SAE prirubnice, kovan

**HANSA FLEX**

## Karakteristike

|                     |  |
|---------------------|--|
| Norma               | DIN 3901/3902  |
| Dodatak kod izvedbe | kovan  |
| Oblik izrade        | Kutevi 90°   |
| Izvedba             | Adapter SAE prirubnice                                 |
| Opseg isporuke      | s 2 polovice prirubnice, kompletno vijaka i O prstenom |
| Materijal           | S355J2G3 (ST52.3)                                      |
| Površinska zaštita  | galvanski premaz                                       |

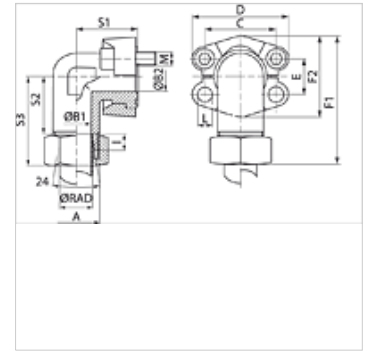

## Napomena

Navedeni maksimalni radni tlak odnosi se na prirubnicu! Stvarni radni tlak određuje cijev (debljina stijenke) i kvaliteta cijevi!

## Artikli

| Naziv               | Tlačni niz | Seri-ja | Ø RAD | PB 10.9 | Velič-ina | A       | B1   | B2   | C    | D     | E    | F1    | F2   | I    | S1   | S2   | S3   | L    | Vijci           |
|---------------------|------------|---------|-------|---------|-----------|---------|------|------|------|-------|------|-------|------|------|------|------|------|------|-----------------|
|                     |            |         | (mm)  | (bar)   |           |         | (mm) | (mm) | (mm) | (mm)  | (mm) | (mm)  | (mm) | (mm) | (mm) | (mm) | (mm) | (mm) |                 |
| WFG 3001/L 15 M     | 3000 PSI   | L       | 15    | 315     | 1/2"      | M22x1,5 | 12   | 11   | 38,1 | 54,0  | 17,5 | 66,8  | 45,6 | 7,0  | 39   | 29,0 | 44   | 8,7  | (4 x) M 8 x 25  |
| WFG 3002/L 18 M     | 3000 PSI   | L       | 18    | 315     | 3/4"      | M26x1,5 | 15   | 19   | 47,6 | 64,9  | 22,2 | 73,9  | 51,8 | 7,5  | 42   | 31,5 | 48   | 10,7 | (4 x) M 10 x 30 |
| WFG 3002/L 22 M     | 3000 PSI   | L       | 22    | 160     | 3/4"      | M30x2   | 19   | 19   | 47,6 | 64,9  | 22,2 | 75,9  | 51,8 | 7,5  | 42   | 33,5 | 50   | 10,7 | (4 x) M 10 x 30 |
| WFG 3003/L 28 M     | 3000 PSI   | L       | 28    | 160     | 1"        | M36x2   | 24   | 25   | 52,4 | 69,9  | 26,2 | 82,2  | 58,4 | 7,5  | 45   | 36,5 | 53   | 10,7 | (4 x) M 10 x 30 |
| WFG 3004/L 35 M     | 3000 PSI   | L       | 35    | 160     | 1.1/4"    | M45x2   | 30   | 27   | 58,7 | 79,4  | 30,2 | 104,3 | 72,6 | 10,5 | 50   | 46,5 | 68   | *1   | *2              |
| WFG 3005/L 42 M     | 3000 PSI   | L       | 42    | 160     | 1.1/2"    | M52x2   | 36   | 36   | 69,9 | 93,8  | 35,7 | 118,2 | 82,4 | 11,0 | 76   | 56,0 | 77   | 13,5 | (4 x) M 12 x 40 |
| WFG 3001/S 16 M     | 3000 PSI   | S       | 16    | 350     | 1/2"      | M24x1,5 | 12   | 11   | 38,1 | 54,0  | 17,5 | 70,8  | 45,6 | 8,5  | 39   | 29,5 | 48   | 8,7  | (4 x) M 8 x 25  |
| WFG 3002/S 20 M     | 3000 PSI   | S       | 20    | 350     | 3/4"      | M30x2   | 16   | 19   | 47,6 | 64,9  | 22,2 | 79,9  | 51,8 | 10,5 | 42   | 32,5 | 54   | 10,7 | (4 x) M 10 x 30 |
| WFG 3002/S 25 M     | 3000 PSI   | S       | 25    | 350     | 3/4"      | M36x2   | 17   | 19   | 47,6 | 64,9  | 22,2 | 82,9  | 51,8 | 12,0 | 42   | 33,0 | 57   | 10,7 | (4 x) M 10 x 30 |
| WFG 3003/S 25 M     | 3000 PSI   | S       | 25    | 315     | 1"        | M36x2   | 20   | 25   | 52,4 | 69,9  | 26,2 | 91,2  | 58,4 | 12,0 | 45   | 38,0 | 62   | 10,7 | (4 x) M 10 x 30 |
| WFG 3003/S 30 M     | 3000 PSI   | S       | 30    | 315     | 1"        | M42x2   | 24   | 25   | 52,4 | 69,9  | 26,2 | 92,2  | 58,4 | 13,5 | 45   | 36,5 | 63   | 10,7 | (4 x) M 10 x 30 |
| WFG 3004/S 25 M     | 3000 PSI   | S       | 25    | 250     | 1.1/4"    | M36x2   | 20   | 27   | 58,7 | 79,4  | 30,2 | 103,3 | 72,6 | 12,0 | 50   | 43,0 | 67   | *1   | *2              |
| WFG 3004/S 30 M     | 3000 PSI   | S       | 30    | 250     | 1.1/4"    | M42x2   | 25   | 27   | 58,7 | 79,4  | 30,2 | 106,3 | 72,6 | 13,5 | 50   | 43,5 | 70   | *1   | *2              |
| WFG 3004/S 38 M     | 3000 PSI   | S       | 38    | 250     | 1.1/4"    | M52x2   | 28   | 27   | 58,7 | 79,4  | 30,2 | 110,3 | 72,6 | 16,0 | 50   | 43,0 | 74   | *1   | *2              |
| WFG 3005/S 38 M     | 3000 PSI   | S       | 38    | 200     | 1.1/2"    | M52x2   | 32   | 36   | 69,9 | 93,8  | 35,7 | 128,2 | 82,4 | 16,0 | 76   | 56,0 | 87   | 13,5 | (4 x) M 12 x 40 |
| WFG 6001/S 16 M     | 6000 PSI   | S       | 16    | 400     | 1/2"      | M24x1,5 | 12   | 12   | 40,5 | 56,4  | 18,2 | 71,6  | 47,2 | 8,5  | 39   | 29,4 | 48   | 8,7  | (4 x) M 8 x 30  |
| WFG 6002/S 16 M     | 6000 PSI   | S       | 16    | 400     | 3/4"      | M24x1,5 | 12   | 17   | 50,8 | 71,3  | 23,8 | 85,0  | 60,0 | 8,5  | 48   | 36,5 | 55   | 10,7 | (4 x) M 10 x 35 |
| WFG 6002/S 20 M     | 6000 PSI   | S       | 20    | 400     | 3/4"      | M30x2   | 16   | 17   | 50,8 | 71,3  | 23,8 | 87,0  | 60,0 | 10,5 | 48   | 35,5 | 57   | 10,7 | (4 x) M 10 x 35 |
| WFG 6002/S 25 M     | 6000 PSI   | S       | 25    | 400     | 3/4"      | M36x2   | 17   | 17   | 50,8 | 71,3  | 23,8 | 90,0  | 60,0 | 12,0 | 48   | 36,0 | 60   | 10,7 | (4 x) M 10 x 35 |
| WFG 6003/S 25 M     | 6000 PSI   | S       | 25    | 400     | 1"        | M36x2   | 20   | 24   | 57,2 | 81,0  | 27,8 | 99,8  | 69,0 | 12,0 | 60   | 41,0 | 65   | 13,0 | (4 x) M 12 x 45 |
| WFG 6003/S 30 M     | 6000 PSI   | S       | 30    | 400     | 1"        | M42x2   | 24   | 24   | 57,2 | 81,0  | 27,8 | 102,9 | 69,0 | 13,5 | 60   | 41,5 | 68   | 13,0 | (4 x) M 12 x 45 |
| WFG 6004/S 30 M     | 6000 PSI   | S       | 30    | 400     | 1.1/4"    | M42x2   | 25   | 31   | 66,7 | 95,2  | 31,8 | 109,6 | 77,2 | 13,5 | 68   | 44,5 | 71   | 14,7 | (4 x) M 14 x 50 |
| WFG 6004/S 38 M     | 6000 PSI   | S       | 38    | 350     | 1.1/4"    | M52x2   | 28   | 31   | 66,7 | 95,2  | 31,8 | 114,6 | 77,2 | 16,0 | 68   | 45,0 | 76   | 14,7 | (4 x) M 14 x 50 |
| WFG 6004/S 38-400 M | 6000 PSI   | S       | 38    | 400     | 1.1/4"    | M52x2   | 22   | 24   | 66,7 | 95,2  | 31,8 | 114,5 | 77,2 | 16,0 | 68   | 45,0 | 76   | 14,7 | (4 x) M 14 x 50 |
| WFG 6005/S 38 M     | 6000 PSI   | S       | 38    | 350     | 1.1/2"    | M52x2   | 30   | 36   | 79,4 | 112,8 | 36,5 | 134,5 | 95,0 | 16,0 | 76   | 56,0 | 87   | 17,0 | (4 x) M 16 x 55 |

Serijska: LL = veoma lagan L = lagan S = težak - PN = nazivni tlak PB = maks. radni tlak - Ø RAD = vanjski promjer cijevi

\*1) = prema odabiru 10,5 ili 12,5 - \*2) = prema odabiru M 10 x 30 ili M 12 x 40

## Varijante proizvoda

WFG (3000 PSI) Adapter SAE prirubnice, kovan, samo prirubnica