

# WFG JIC (6000 PSI)

Adapter SAE prirubnice, kovan

**HANSA FLEX**

## Karakteristike

Tlačni niz	6000 psi
Norma	SAE J 518 C ISO 6162
Dodatak kod izvedbe	kovan
Oblik izrade	Kutevi 90°
Izvedba	Adapter SAE prirubnice
Opseg isporuke	samo prirubnica
Materijal	S355J2G3 (ST52.3)
Površinska zaštita	galvanski premaz

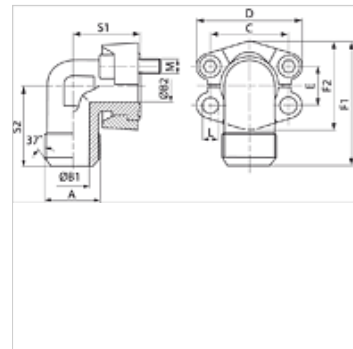
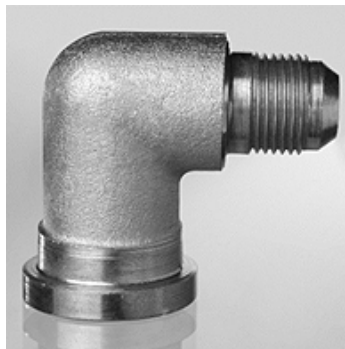

## Napomena

Navedeni maksimalni radni tlak odnosi se na prirubnicu! Stvarni radni tlak određuje cijev (debljina stjenke) i kvaliteta cijevi!

Preporučeni vijci navedeni su u stupcu M (metr) ili M (unc).

## Artikli

Naziv	PB 10.9 (bar)	Veličina	A	B1 (mm)	B2 (mm)	E (mm)	F1 (mm)	S1 (mm)	S2 (mm)	L (mm)	M metr.	M unc
WFG 6001 JIC 3/4	400	1/2"	UNF 3/4" -16	9,9	13	18,2	61,6	39	38	8,7	M 8 x 30	5/16" x 1.1/4"
WFG 6001 JIC 7/8	400	1/2"	UNF 7/8" - 14	12,3	13	18,2	61,6	39	38	8,7	M 8 x 35	5/16" x 1.1/4"
WFG 6002 JIC 1 1/16	400	3/4"	UNF 1.1/16" - 12	15,5	17	23,8	78,0	48	48	10,7	M 10 x 35	3/8" x 1.1/2"
WFG 6002 JIC 1 5/16	400	3/4"	UN 1,5/16" -12	21,5	17	23,8	78,0	48	48	10,7	M 10 x 35	3/8" x 1.1/2"
WFG 6002 JIC 7/8	400	3/4"	UNF 7/8" - 14	12,3	17	23,8	78,0	48	48	10,7	M 10 x 35	3/8" x 1.1/2"
WFG 6003 JIC 1 1/16	400	1"	UNF 1.1/16" - 12	15,5	24	27,8	99,0	60	60	*1	M 12 x 45	7/16" x 1.3/4"
WFG 6003 JIC 1 5/16	400	1"	UN 1,5/16" -12	21,5	24	27,8	99,0	60	60	*1	M 12 x 45	7/16" x 1.3/4"
WFG 6003 JIC 1 5/8	400	1"	UN 1,5/8" -12	27,5	24	27,8	99,0	60	60	*1	M 12 x 45	7/16" x 1.3/4"
WFG 6004 JIC 1 5/16	400	1.1/4"	UN 1,5/16" -12	21,5	30	31,8	115,5	68	68	*2	M 14 x 50	1/2" x 1.3/4"
WFG 6004 JIC 1 5/8	400	1.1/4"	UN 1,5/8" -12	27,5	30	31,8	115,5	68	68	*2	M 14 x 50	1/2" x 1.3/4"
WFG 6004 JIC 1 7/8	400	1.1/4"	UN 1,7/8" -12	33,0	30	31,8	115,5	68	68	*2	M 14 x 50	1/2" x 1.3/4"
WFG 6005 JIC 1 5/8	400	1.1/2"	UN 1,5/8" -12	27,5	32	36,5	133,0	76	76	17,0	M 16 x 55	5/8" x 2"
WFG 6005 JIC 1 7/8	400	1.1/2"	UN 1,7/8" -12	33,0	32	36,5	133,0	76	76	17,0	M 16 x 55	5/8" x 2"

PN = nazivni tlak PB = maks. radni tlak

\*1) = prema odabiru 12,0 ili 12,5 - \*2) = prema odabiru 13,5 ili 14,5

## Varijante proizvoda

WFG JIC U (3000 / 6000 PSI) Adapter SAE prirubnice, kovan, s 2 polovice prirubnice, kompletom vijaka i O prstenom

WFG JIC M (3000 / 6000 PSI) Adapter SAE prirubnice, kovan, s 2 polovice prirubnice, kompletom vijaka i O prstenom