

Karakteristike

Priključak 1	metrički vanjski navoji, cilindrični
Oblik brtve 1	Četvrtasti brtveni prsten
Priključak 2	metrički vanjski navoji, cilindrični
Oblik brtve 2	24° unutarnji konus
Izvedba	Zakretni vijčani spojevi, bez prigušivanja
Oblik izrade	Kutevi 90°
Norma	DIN 2353 ISO 8434-1
Opseg isporuke	Nastavak s pretornom maticom i narezanim prstenom
Materijal	Čelik
Površinska zaštita	galvanski premaz

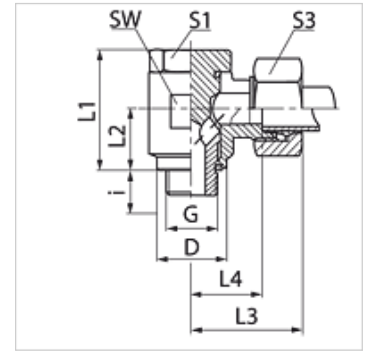

Napomena

Upute za montažu, ugradnju, tlačno opterećenje i dopuštene radne temperature pronaći ćete u tehničkim informacijama za vijčane spojeve cijevi.

Artikli

Naziv	Seriya	Radni tlak bari	Vanjski Ø cijevi (mm)	G	D (mm)	i (mm)	L1 (mm)	L2 (mm)	L3 (mm)	L4 (mm)	SW (mm)	S1	S3
SDM NW 04 HL	L	PN 250	6	M 10 x 1	14	8	24,0	10,5	27	12,0	17	17	14
SDM NW 06 HL	L	PN 250	8	M 12 x 1,5	17	12	30,0	14,0	29	14,5	22	19	17
SDM NW 08 HL	L	PN 250	10	M 14 x 1,5	19	12	30,0	14,0	30	15,5	22	19	19
SDM NW 10 HL	L	PN 250	12	M 16 x 1,5	21	12	36,0	16,5	33	18,0	27	24	22
SDM NW 10 HL 18	L	PN 250	12	M 18 x 1,5	23	12	38,0	17,0	33	13,5	30	27	22
SDM NW 13 HL	L	PN 250	15	M 18 x 1,5	23	12	39,5	18,5	36	20,5	30	27	27
SDM NW 16 HL	L	PN 250	18	M 22 x 1,5	27	14	45,0	21,5	37	21,0	32	30	32
SDM NW 20 HL	L	PN 160	22	M 26 x 1,5	31	16	53,0	24,0	44	27,5	41	36	36
SDM NW 25 HL	L	PN 160	28	M 33 x 2	39	18	66,0	30,5	49	32,0	50	46	41
SDM NW 32 HL	L	PN 160	35	M 42 x 2	49	20	76,0	35,5	58	36,0	60	55	50
SDM NW 40 HL	L	PN 160	42	M 48 x 2	55	22	87,0	40,5	63	40,5	70	60	60
SDM NW 03 HS	S	PN 315	6	M 12 x 1,5	17	12	30,0	14,0	31	16,5	22	19	17
SDM NW 04 HS	S	PN 315	8	M 14 x 1,5	19	12	30,0	14,0	31	16,5	22	19	19
SDM NW 06 HS	S	PN 315	10	M 16 x 1,5	21	12	36,0	16,5	35	18,5	27	24	22
SDM NW 08 HS	S	PN 315	12	M 18 x 1,5	23	12	39,5	18,5	36	20,0	30	27	24
SDM NW 10 HS	S	PN 315	14	M 20 x 1,5	25	14	43,5	20,0	40	22,5	32	30	27
SDM NW 13 HS	S	PN 315	16	M 22 x 1,5	27	14	45,0	21,5	40	22,0	32	30	30
SDM NW 16 HS	S	PN 160	20	M 27 x 2	32	16	53,0	24,0	48	26,5	41	36	36
SDM NW 20 HS	S	PN 160	25	M 33 x 2	39	18	66,0	30,5	56	31,5	50	46	46
SDM NW 25 HS	S	PN 160	30	M 42 x 2	49	20	76,0	35,5	64	37,0	60	55	50
SDM NW 32 HS	S	PN 160	38	M 48 x 2	55	22	87,0	40,5	72	41,5	70	60	60

PN = nazivni tlak PB = maks. radni tlak – Serija: LL = veoma lagan L = lagan S = težak – Ø = vanjski promjer cijevi

Varijante proizvoda

XSDM Zakretni vijčani spoj, bez prigušivanja, W90°, Čelik