

## Karakteristike

|                    |   |
|--------------------|---|
| Priključak 1       | metrički vanjski navoji, cilindrični              |
| Oblik brtve 1      | Profil F  |
| Priključak 2       | metrički vanjski navoji, cilindrični              |
| Oblik brtve 2      | 24° unutarnji konus                               |
| Izvedba            | Zakretni vijčani spojevi, bez prigušivanja        |
| Oblik izrade       | Kutevi 90°  |
| Norma              | DIN 2353<br>ISO 8434-1                            |
| Opseg isporuke     | Nastavak s pretornom maticom i narezanim prstenom |
| Materijal          | Čelik   |
| Površinska zaštita | galvanski premaz                                  |

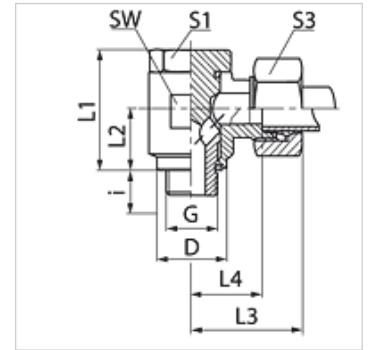

## Napomena

Upute za montažu, ugradnju, tlačno opterećenje i dopuštene radne temperature pronaći ćete u tehničkim informacijama za vijčane spojeve cijevi.

## Artikli

| Naziv            | Seriya | Radni tlak bari | Vanjski Ø cijevi (mm) | G          | D (mm) | i (mm) | L1 (mm) | L2 (mm) | L3 (mm) | L4 (mm) | SW (mm) | S1 | S3 | OR           |
|------------------|--------|-----------------|-----------------------|------------|--------|--------|---------|---------|---------|---------|---------|----|----|--------------|
| SDOM 06 LL       | LL     | PN 100          | 6                     | M 10 x 1   | 14,7   | 8,0    | 23,5    | 10,5    | 28,0    | 13,5    | 17      | 17 | 12 | 7,65 x 1,78  |
| SDOM 08 LL       | LL     | PN 100          | 8                     | M 10 x 1   | 14,7   | 8,0    | 23,5    | 10,5    | 28,0    | 13,5    | 17      | 17 | 14 | 7,65 x 1,78  |
| SDOM NW 04 HL    | L      | PN 315          | 6                     | M 10 x 1   | 14,0   | 8,0    | 24,0    | 10,5    | 27,0    | 12,0    | 17      | 17 | 14 | 7,65 x 1,78  |
| SDOM NW 06 HL    | L      | PN 315          | 8                     | M 12 x 1,5 | 17,0   | 12,0   | 30,0    | 14,0    | 29,0    | 14,5    | 22      | 19 | 17 | 11,10 x 1,78 |
| SDOM NW 08 HL    | L      | PN 315          | 10                    | M 14 x 1,5 | 19,0   | 12,0   | 30,0    | 14,0    | 30,0    | 15,5    | 22      | 19 | 19 | 11,10 x 1,78 |
| SDOM NW 10 HL    | L      | PN 315          | 12                    | M 16 x 1,5 | 21,0   | 12,0   | 36,0    | 16,5    | 33,0    | 18,0    | 27      | 24 | 22 | 14,00 x 1,78 |
| SDOM NW 10 HL 18 | L      | PN 315          | 12                    | M 18 x 1,5 | 23,5   | 12,0   | 35,0    | 16,5    | 33,0    | 18,0    | 27      | 24 | 22 | 18,77 x 1,78 |
| SDOM NW 13 HL    | L      | PN 315          | 15                    | M 18 x 1,5 | 23,0   | 12,0   | 39,5    | 18,5    | 37,0    | 21,5    | 30      | 27 | 27 | 18,77 x 1,78 |
| SDOM NW 16 HL    | L      | PN 315          | 18                    | M 22 x 1,5 | 27,0   | 14,0   | 45,0    | 21,5    | 37,0    | 21,0    | 32      | 30 | 32 | 18,77 x 1,78 |
| SDOM NW 20 HL    | L      | PN 160          | 22                    | M 26 x 1,5 | 31,0   | 16,0   | 53,0    | 24,0    | 44,0    | 27,5    | 41      | 36 | 36 | 23,81 x 2,62 |
| SDOM NW 25 HL    | L      | PN 160          | 28                    | M 33 x 2   | 39,0   | 18,0   | 66,0    | 30,5    | 49,0    | 32,0    | 50      | 46 | 41 | 29,82 x 2,62 |
| SDOM NW 32 HL    | L      | PN 160          | 35                    | M 42 x 2   | 49,0   | 20,0   | 76,0    | 35,5    | 58,0    | 36,0    | 60      | 55 | 50 | 37,77 x 2,62 |
| SDOM NW 40 HL    | L      | PN 160          | 42                    | M 48 x 2   | 55,0   | 22,0   | 87,0    | 40,5    | 63,0    | 40,5    | 70      | 60 | 60 | 41,28 x 3,53 |
| SDOM NW 03 HS    | S      | PN 400          | 6                     | M 12 x 1,5 | 17,0   | 12,0   | 30,0    | 14,0    | 31,0    | 16,5    | 22      | 19 | 17 | 11,10 x 1,78 |
| SDOM NW 04 HS    | S      | PN 400          | 8                     | M 14 x 1,5 | 19,0   | 12,0   | 30,0    | 14,0    | 31,0    | 16,5    | 22      | 19 | 19 | 11,10 x 1,78 |
| SDOM NW 06 HS    | S      | PN 400          | 10                    | M 16 x 1,5 | 21,0   | 12,0   | 35,0    | 16,5    | 35,0    | 18,5    | 27      | 24 | 22 | 14,00 x 1,78 |
| SDOM NW 08 HS    | S      | PN 400          | 12                    | M 18 x 1,5 | 23,0   | 12,0   | 39,5    | 18,5    | 36,0    | 20,0    | 30      | 27 | 24 | 18,77 x 1,78 |
| SDOM NW 10 HS    | S      | PN 400          | 14                    | M 20 x 1,5 | 25,0   | 14,0   | 43,5    | 20,0    | 40,0    | 22,5    | 32      | 30 | 27 | 18,77 x 1,78 |
| SDOM NW 13 HS    | S      | PN 315          | 16                    | M 22 x 1,5 | 27,0   | 14,0   | 45,0    | 21,5    | 40,0    | 22,0    | 32      | 30 | 30 | 18,77 x 1,78 |
| SDOM NW 16 HS    | S      | PN 315          | 20                    | M 27 x 2   | 32,0   | 16,0   | 53,0    | 24,0    | 48,0    | 26,5    | 41      | 36 | 36 | 23,81 x 2,62 |
| SDOM NW 20 HS    | S      | PN 250          | 25                    | M 33 x 2   | 39,0   | 18,0   | 66,0    | 30,5    | 56,0    | 31,5    | 50      | 46 | 46 | 29,38 x 2,62 |
| SDOM NW 25 HS    | S      | PN 160          | 30                    | M 42 x 2   | 49,0   | 20,0   | 76,0    | 35,5    | 64,0    | 37,0    | 60      | 55 | 50 | 37,77 x 2,62 |
| SDOM NW 32 HS    | S      | PN 160          | 38                    | M 48 x 2   | 55,0   | 22,0   | 87,0    | 40,5    | 72,0    | 41,5    | 70      | 60 | 60 | 41,28 x 3,53 |

PN = nazivni tlak PB = maks. radni tlak – Seriya: LL = veoma lagan L = lagan S = težak – Ø = vanjski promjer cijevi

## Varijante proizvoda

|         |  |
|---------|--|
| SDOM VA | Zakretni vijčani spoj, bez prigušivanja, W90°, Oplemenjeni čelik |
| XSDOM   | Zakretni vijčani spoj, bez prigušivanja, W90°, Čelik             |