

## Karakteristike

|                    |   |
|--------------------|---|
| Priključak 1       | BSP vanjski navoj, cilindrični                    |
| Oblik brtve 1      | Profil F  |
| Priključak 2       | metrički vanjski navoji, cilindrični              |
| Oblik brtve 2      | 24° unutarnji konus                               |
| Izvedba            | Zakretni vijčani spojevi, bez prigušivanja        |
| Oblik izrade       | Kutevi 90°  |
| Norma              | DIN 2353<br>ISO 8434-1                            |
| Opseg isporuke     | Nastavak s pretornom maticom i narezanim prstenom |
| Materijal          | Čelik   |
| Površinska zaštita | galvanski premaz                                  |

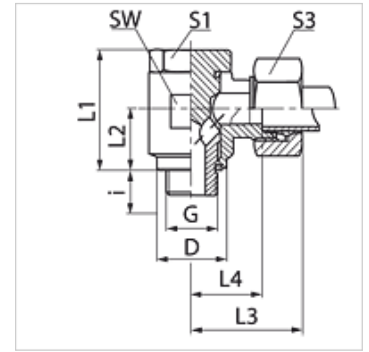

## Napomena

Upute za montažu, ugradnju, tlačno opterećenje i dopuštene radne temperature pronaći ćete u tehničkim informacijama za vijčane spojeve cijevi.

## Artikli

| Naziv         | Seriya | Radni tlak bari | Vanjski Ø cijevi (mm) | G             | D (mm) | i (mm) | L1 (mm) | L2 (mm) | L3 (mm) | L4 (mm) | SW (mm) | S1 | S3 | OR           |
|---------------|--------|-----------------|-----------------------|---------------|--------|--------|---------|---------|---------|---------|---------|----|----|--------------|
| SDOR 04 LL    | LL     | PN 100          | 4                     | G 1/8" - 28   | 14,7   | 8,0    | 23,5    | 10,5    | 29,0    | 14,0    | 17      | 17 | 10 | 7,65 x 1,78  |
| SDOR 06 LL    | LL     | PN 100          | 6                     | G 1/8" - 28   | 13,5   | 8,0    | 23,5    | 10,5    | 28,5    | 13,5    | 17      | 17 | 12 | 7,65 x 1,78  |
| SDOR 08 LL    | LL     | PN 100          | 8                     | G 1/8" - 28   | 14,7   | 8,0    | 23,5    | 10,5    | 28,5    | 13,5    | 17      | 17 | 14 | 7,65 x 1,78  |
| SDOR NW 04 HL | L      | PN 315          | 6                     | G 1/8" - 28   | 14,0   | 8,0    | 24,0    | 10,5    | 27,0    | 12,0    | 17      | 17 | 14 | 7,65 x 1,78  |
| SDOR NW 06 HL | L      | PN 315          | 8                     | G 1/4" - 19   | 18,0   | 12,0   | 30,0    | 14,0    | 29,0    | 14,5    | 22      | 19 | 17 | 11,10 x 1,78 |
| SDOR NW 08 HL | L      | PN 315          | 10                    | G 1/4" - 19   | 18,0   | 12,0   | 30,0    | 14,0    | 30,0    | 15,5    | 22      | 19 | 19 | 11,10 x 1,78 |
| SDOR NW 10 HL | L      | PN 315          | 12                    | G 3/8" - 19   | 22,0   | 12,0   | 36,0    | 16,5    | 33,0    | 18,0    | 27      | 24 | 22 | 14,00 x 1,78 |
| SDOR NW 13 HL | L      | PN 315          | 15                    | G 1/2" - 14   | 26,0   | 14,0   | 45,0    | 21,5    | 37,0    | 21,5    | 32      | 30 | 27 | 18,77 x 1,78 |
| SDOR NW 16 HL | L      | PN 315          | 18                    | G 1/2" - 14   | 26,0   | 14,0   | 45,0    | 21,5    | 37,0    | 21,0    | 32      | 30 | 32 | 18,77 x 1,78 |
| SDOR NW 20 HL | L      | PN 160          | 22                    | G 3/4" - 14   | 32,0   | 16,0   | 53,0    | 24,0    | 44,0    | 27,5    | 41      | 36 | 36 | 23,81 x 2,62 |
| SDOR NW 25 HL | L      | PN 160          | 28                    | G 1" - 11     | 39,0   | 18,0   | 66,0    | 30,5    | 49,0    | 32,0    | 50      | 46 | 41 | 29,82 x 2,62 |
| SDOR NW 32 HL | L      | PN 160          | 35                    | G 1,1/4" - 11 | 49,0   | 20,0   | 76,0    | 35,5    | 58,0    | 36,0    | 60      | 55 | 50 | 37,77 x 2,62 |
| SDOR NW 40 HL | L      | PN 160          | 42                    | G 1,1/2" - 11 | 55,0   | 22,0   | 87,0    | 40,5    | 63,0    | 40,5    | 70      | 60 | 60 | 41,28 x 3,53 |
| SDOR NW 03 HS | S      | PN 400          | 6                     | G 1/4" - 19   | 18,0   | 12,0   | 30,0    | 14,0    | 31,0    | 16,5    | 22      | 19 | 17 | 11,10 x 1,78 |
| SDOR NW 04 HS | S      | PN 400          | 8                     | G 1/4" - 19   | 18,0   | 12,0   | 30,0    | 14,0    | 31,0    | 16,5    | 22      | 19 | 19 | 11,10 x 1,78 |
| SDOR NW 06 HS | S      | PN 400          | 10                    | G 3/8" - 19   | 22,0   | 12,0   | 36,0    | 16,5    | 35,0    | 18,5    | 27      | 24 | 22 | 14,00 x 1,78 |
| SDOR NW 08 HS | S      | PN 400          | 12                    | G 3/8" - 19   | 22,0   | 12,0   | 36,0    | 16,5    | 35,0    | 18,5    | 27      | 24 | 24 | 14,00 x 1,78 |
| SDOR NW 10 HS | S      | PN 400          | 14                    | G 1/2" - 14   | 26,0   | 14,0   | 45,0    | 21,5    | 40,0    | 22,5    | 32      | 30 | 27 | 18,77 x 1,78 |
| SDOR NW 13 HS | S      | PN 315          | 16                    | G 1/2" - 14   | 26,0   | 14,0   | 45,0    | 21,5    | 40,0    | 22,0    | 32      | 30 | 30 | 18,77 x 1,78 |
| SDOR NW 16 HS | S      | PN 315          | 20                    | G 3/4" - 14   | 32,0   | 16,0   | 53,0    | 24,0    | 48,0    | 26,5    | 41      | 36 | 36 | 23,81 x 2,62 |
| SDOR NW 20 HS | S      | PN 250          | 25                    | G 1" - 11     | 39,0   | 18,0   | 66,0    | 30,5    | 56,0    | 31,5    | 50      | 46 | 46 | 29,82 x 2,62 |
| SDOR NW 25 HS | S      | PN 160          | 30                    | G 1,1/4" - 11 | 49,0   | 20,0   | 76,0    | 35,5    | 64,0    | 37,0    | 60      | 55 | 50 | 37,77 x 2,62 |
| SDOR NW 32 HS | S      | PN 160          | 38                    | G 1,1/2" - 11 | 55,0   | 22,0   | 87,0    | 40,5    | 72,0    | 41,5    | 70      | 60 | 60 | 41,28 x 3,53 |

PN = nazivni tlak PB = maks. radni tlak - Seriya: LL = veoma lagan L = lagan S = težak - Ø d2 = vanjski promjer cijevi

## Varijante proizvoda

|         |  |
|---------|--|
| SDOR VA | Zakretni vijčani spoj, bez prigušivanja, W90°, Oplemenjeni čelik |
| XSDOR   | Zakretni vijčani spoj, bez prigušivanja, W90°, Čelik             |