

### Karakteristike

|                       |   |
|-----------------------|---|
| <b>Priključak 1</b>   | BSP vanjski navoj, konusni                        |
| <b>Oblik brtve 1</b>  | brtvljenje navoja                                 |
| <b>Priključak 2</b>   | metrički vanjski navoji, cilindrični              |
| <b>Oblik brtve 2</b>  | 24° unutarnji konus                               |
| <b>Izvedba</b>        | Uvrtni vijčani spoj                               |
| <b>Oblik izrade</b>   | Kutevi 90°  |
| <b>Norma</b>          | DIN 2353<br>ISO 8434-1                            |
| <b>Opseg isporuke</b> | Nastavak s pretornom maticom i narezanim prstenom |
| <b>Materijal</b>      | Mjed  |

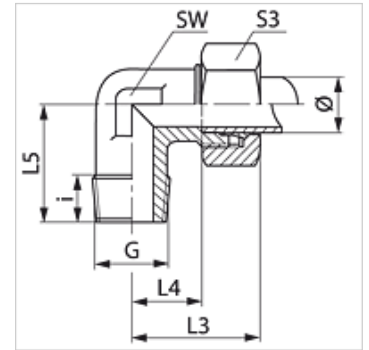

### Napomena

Upute za montažu, ugradnju, tlačno opterećenje i dopuštene radne temperature pronaći ćete u tehničkim informacijama za vijčane spojeve cijevi.

### Artikli

| Naziv              | Seriya | Radni tlak bari | Vanjski Ø cijevi (mm) | G        | i (mm) | L3 (mm) | L4 (mm) | L5 (mm) | SW (mm) | S3 |
|--------------------|--------|-----------------|-----------------------|----------|--------|---------|---------|---------|---------|----|
| WR 04 LL MG        | LL     | PN 63           | 4                     | R 1/8" K | 8      | 21      | 11,0    | 18      | 11      | 10 |
| WR 05 LL MG        | LL     | PN 63           | 5                     | R 1/8" K | 8      | 22      | 10,0    | 17      | 11      | 12 |
| WR 06 LL MG        | LL     | PN 63           | 6                     | R 1/8" K | 8      | 22      | 10,0    | 17      | 11      | 12 |
| WR 08 LL MG        | LL     | PN 63           | 8                     | R 1/8" K | 8      | 23      | 11,5    | 20      | 12      | 14 |
| WR 10 LL MG        | LL     | PN 63           | 10                    | R 1/4" K | 12     | 27      | 15,5    | 26      | 14      | 17 |
| WR 12 LL MG        | LL     | PN 63           | 12                    | R 1/4" K | 12     | 27      | 15,0    | 27      | 17      | 19 |
| WR NW 04 HL MG     | L      | PN 200          | 6                     | R 1/8" K | 8      | 27      | 12,0    | 20      | 12      | 14 |
| WR NW 04 HL 1/4 MG | L      | PN 200          | 6                     | R 1/4" K | 12     | 29      | 14,0    | 26      | 12      | 14 |
| WR NW 06 HL MG     | L      | PN 200          | 8                     | R 1/4" K | 12     | 29      | 14,0    | 26      | 12      | 17 |
| WR NW 08 HL MG     | L      | PN 200          | 10                    | R 1/4" K | 12     | 30      | 15,0    | 27      | 14      | 19 |
| WR NW 10 HL MG     | L      | PN 200          | 12                    | R 3/8" K | 12     | 32      | 17,0    | 28      | 17      | 22 |
| WR NW 10 HL 1/4 MG | L      | PN 200          | 12                    | R 1/4" K | 12     | 32      | 17,0    | 28      | 17      | 22 |
| WR NW 10 HL 1/2 MG | L      | PN 200          | 12                    | R 1/2" K | 14     | 38      | 23,0    | 34      | 19      | 22 |
| WR NW 13 HL MG     | L      | PN 200          | 15                    | R 1/2" K | 14     | 36      | 21,0    | 34      | 19      | 27 |
| WR NW 16 HL MG     | L      | PN 200          | 18                    | R 1/2" K | 14     | 40      | 23,5    | 36      | 24      | 32 |
| WR NW 03 HS MG     | S      | PN 250          | 6                     | R 1/4" K | 12     | 31      | 16,0    | 26      | 12      | 17 |
| WR NW 04 HS MG     | S      | PN 250          | 8                     | R 1/4" K | 12     | 32      | 17,0    | 27      | 17      | 19 |
| WR NW 06 HS MG     | S      | PN 250          | 10                    | R 3/8" K | 12     | 34      | 17,5    | 28      | 17      | 22 |
| WR NW 13 HS MG     | S      | PN 250          | 16                    | R 1/2" K | 14     | 43      | 24,5    | 32      | 24      | 30 |

Seriya: LL = veoma lagan L = lagan S = težak – PN = nazivni tlak PB = maks. radni tlak – Ø = vanjski promjer cijevi

### Varijante proizvoda

|               |   |
|---------------|---|
| <b>WRK</b>    | Uvrtni vijčani spoj, kut 90°, Čelik             |
| <b>WRK VA</b> | Uvrtni vijčani spoj, kut 90°, Oplemenjeni čelik |