

XSDOR VA

Zakretni vijčani spoj, bez prigušivanja, W90°

HANSA FLEX

Karakteristike

Priključak 1	BSP vanjski navoj, cilindrični
Oblik brtve 1	Profil E
Priključak 2	metrički vanjski navoji, cilindrični
Oblik brtve 2	24° unutarnji konus
Izvedba	Zakretni vijčani spojevi, bez prigušivanja
Oblik izrade	Kutevi 90°
Norma	DIN 2353 ISO 8434-1
Opseg isporuke	Nastavak (bez preturane matice i nareznog prstena)
Materijal	Oplemenjeni čelik

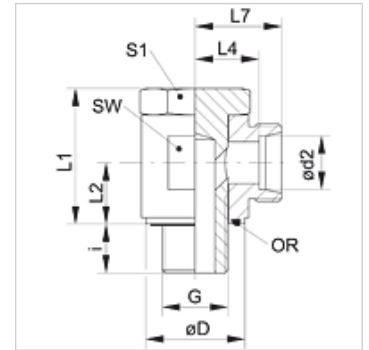

Napomena

Upute za montažu, ugradnju, tlačno opterećenje i dopuštene radne temperature pronaći ćete u tehničkim informacijama za vijčane spojeve cijevi.

Napomene uz narudžbu

Ulošci NBR ulošci brtve
FPM (Viton) na zahtjev

Artikli

Naziv	Serija	Radni tlak bari	Ø d2 (mm)	G	Ø D (mm)	i (mm)	L1 (mm)	L2 (mm)	L4 (mm)	L7 (mm)	SW (mm)	S1	OR
XSDOR 04 LL VA	LL	PN 100	4	G 1/8" - 28	14,5	8,0	23,5	10,5	14,0	18,0	17	17	7,65 x 1,78
XSDOR 06 LL VA	LL	PN 100	6	G 1/8" - 28	14,5	8,0	23,5	10,5	13,5	19,0	17	17	7,65 x 1,78
XSDOR 08 LL VA	LL	PN 100	8	G 1/8" - 28	14,5	8,0	23,5	10,5	13,5	19,0	17	17	7,65 x 1,78
XSDOR NW 04 HL VA	L	PN 315	6	G 1/8" - 28	14,5	8,0	23,5	10,5	12,0	19,0	17	17	7,65 x 1,78
XSDOR NW 06 HL VA	L	PN 315	8	G 1/4" - 19	19,0	13,0	29,0	14,0	14,5	21,5	22	19	11,10 x 1,78
XSDOR NW 08 HL VA	L	PN 315	10	G 1/4" - 19	19,0	12,5	29,0	14,0	15,5	22,5	22	19	11,10 x 1,78
XSDOR NW 10 HL 1/4 VA	L	PN 315	12	G 1/4" - 19	19,0	12,0	34,0	16,5	18,0	25,0	27	19	11,10 x 1,78
XSDOR NW 10 HL VA	L	PN 315	12	G 3/8" - 19	22,5	12,0	35,0	16,5	18,0	25,0	27	24	14,00 x 1,78
XSDOR NW 13 HL VA	L	PN 315	15	G 1/2" - 14	27,0	12,0	46,0	21,5	21,5	28,5	32	27	18,77 x 1,78
XSDOR NW 16 HL VA	L	PN 315	18	G 1/2" - 14	27,0	14,0	46,0	21,5	21,0	28,5	32	27	18,77 x 1,78
XSDOR NW 20 HL VA	L	PN 160	22	G 3/4" - 14	32,5	16,0	52,0	24,0	27,5	35,0	41	36	23,81 x 2,62
XSDOR NW 25 HL VA	L	PN 160	28	G 1" - 11	40,0	18,0	64,0	30,5	32,0	39,5	50	46	29,82 x 2,62
XSDOR NW 32 HL VA	L	PN 160	35	G 1,1/4" - 11	50,0	20,0	75,0	35,5	36,0	46,5	60	50	37,77 x 2,62
XSDOR NW 40 HL VA	L	PN 160	42	G 1,1/2" - 11	55,5	22,0	74,0	40,5	40,5	51,5	70	60	41,28 x 3,53
XSDOR NW 03 HS VA	S	PN 400	6	G 1/4" - 19	19,0	13,0	29,0	14,0	16,5	23,5	22	19	11,10 x 1,78
XSDOR NW 04 HS VA	S	PN 400	8	G 1/4" - 19	19,0	13,0	29,0	14,0	16,5	23,5	22	19	11,10 x 1,78
XSDOR NW 06 HS VA	S	PN 400	10	G 3/8" - 19	22,5	12,0	35,5	16,5	18,5	26,0	27	24	14,00 x 1,78
XSDOR NW 08 HS VA	S	PN 400	12	G 3/8" - 19	22,5	12,0	35,0	16,5	18,5	26,0	27	24	14,00 x 1,78
XSDOR NW 10 HS VA	S	PN 400	14	G 1/2" - 14	27,0	12,0	46,0	21,5	22,5	30,5	30	27	18,77 x 1,78
XSDOR NW 13 HS VA	S	PN 315	16	G 1/2" - 14	27,0	14,0	46,0	21,5	22,0	30,5	30	27	18,77 x 1,78
XSDOR NW 16 HS VA	S	PN 315	20	G 3/4" - 14	32,5	16,0	52,0	24,0	26,5	37,0	41	36	23,81 x 2,62
XSDOR NW 20 HS VA	S	PN 250	25	G 1" - 11	40,0	19,0	63,0	30,5	31,5	43,5	50	46	29,82 x 2,62
XSDOR NW 25 HS VA	S	PN 160	30	G 1,1/4" - 11	50,0	20,0	75,0	35,5	37,0	50,5	60	50	37,77 x 2,62
XSDOR NW 32 HS VA	S	PN 160	38	G 1,1/2" - 11	55,5	22,0	74,0	40,5	41,5	57,5	70	60	41,28 x 3,53

PN = nazivni tlak PB = maks. radni tlak - Serija: LL = veoma lagan L = lagan S = težak - Ø = vanjski promjer cijevi

Varijante proizvoda

XSDOR	Zakretni vijčani spoj, bez prigušivanja, W90°, Čelik
SDOR VA	Zakretni vijčani spoj, bez prigušivanja, W90°, Oplemenjeni čelik