

# XVEWO 45

Vijčani spoj, kut 45°

## Karakteristike

<b>Priključak 1</b>	metrički navoji matice
<b>Oblik brtve 1</b>	24° vanjski konus s O prstenom
<b>Priključak 2</b>	metrički vanjski navoji, cilindrični
<b>Oblik brtve 2</b>	24° unutarnji konus
<b>Izvedba</b>	Vijčani spojevi, podesivi po smjeru
<b>Oblik izrade</b>	Kutevi 45°
<b>Opseg isporuke</b>	Nastavak (bez pretorne matice i narezanog prstena)
<b>Materijal</b>	Čelik
<b>Površinska zaštita</b>	galvanski premaz

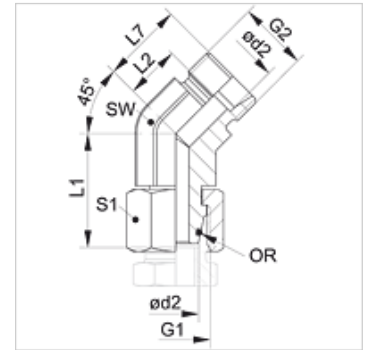

## Napomena

Upute za montažu, ugradnju, tlačno opterećenje i dopuštene radne temperature pronaći ćete u tehničkim informacijama za vijčane spojeve cijevi.

## Artikli

Naziv	Seriya	Radni tlak bari	Ø d2 (mm)	G1 + G2	L1 (mm)	L2 (mm)	L7 (mm)	SW (mm)	S1	OR
XVEWO 45 NW 04 HL	L	PN 315	6	M 12 x 1,5	26,0	9,0	16,0	14	14	4,0 x 1,5
XVEWO 45 NW 06 HL	L	PN 315	8	M 14 x 1,5	27,5	12,0	19,0	14	17	6,0 x 1,5
XVEWO 45 NW 08 HL	L	PN 315	10	M 16 x 1,5	29,0	12,0	19,0	19	19	7,5 x 1,5
XVEWO 45 NW 10 HL	L	PN 315	12	M 18 x 1,5	29,5	14,0	21,0	19	22	9,0 x 1,5
XVEWO 45 NW 13 HL	L	PN 315	15	M 22 x 1,5	32,5	17,0	24,0	22	27	12,0 x 2,0
XVEWO 45 NW 16 HL	L	PN 315	18	M 26 x 1,5	35,5	16,5	24,0	27	32	15,0 x 2,0
XVEWO 45 NW 20 HL	L	PN 160	22	M 30 x 2	38,5	18,5	26,0	30	36	20,0 x 2,0
XVEWO 45 NW 25 HL	L	PN 160	28	M 36 x 2	41,5	23,0	30,5	36	41	26,0 x 2,0
XVEWO 45 NW 32 HL	L	PN 160	35	M 45 x 2	51,0	26,5	37,0	50	50	32,0 x 2,5
XVEWO 45 NW 40 HL	L	PN 160	42	M 52 x 2	56,0	26,0	37,0	50	60	38,0 x 2,5
XVEWO 45 NW 03 HS	S	PN 630	6	M 14 x 1,5	27,0	9,0	16,0	14	17	4,0 x 1,5
XVEWO 45 NW 04 HS	S	PN 630	8	M 16 x 1,5	27,5	12,0	19,0	19	19	6,0 x 1,5
XVEWO 45 NW 06 HS	S	PN 630	10	M 18 x 1,5	30,0	13,5	21,0	19	22	7,5 x 1,5
XVEWO 45 NW 08 HS	S	PN 630	12	M 20 x 1,5	31,0	16,5	24,0	19	24	9,0 x 1,5
XVEWO 45 NW 13 HS	S	PN 400	16	M 24 x 1,5	36,5	15,5	24,0	19	30	12,0 x 2,0
XVEWO 45 NW 16 HS	S	PN 400	20	M 30 x 2	44,5	16,0	26,5	27	36	16,3 x 2,4
XVEWO 45 NW 20 HS	S	PN 400	25	M 36 x 2	50,0	18,5	30,5	36	46	20,3 x 2,4
XVEWO 45 NW 25 HS	S	PN 400	30	M 42 x 2	55,0	23,5	37,0	50	50	25,3 x 2,4
XVEWO 45 NW 32 HS	S	PN 315	38	M 52 x 2	63,0	21,0	37,0	50	60	33,3 x 2,4

Seriya: LL = veoma lagan L = lagan S = težak – PN = nazivni tlak PB = maks. radni tlak – Ø d2 = vanjski promjer cijevi

## Varijante proizvoda

<b>XVEWO 45 VA</b>	Vijčani spoj, kut 45°, Oplemenjeni čelik
<b>VEWO 45</b>	Vijčani spoj, kut 45°, Čelik