

Karakteristike

Priključak 1	metrički vanjski navoj, konusni
Oblik brtve 1	brtvljenje navoja
Priključak 2	metrički vanjski navoji, cilindrični
Oblik brtve 2	24° unutarnji konus
Izvedba	Uvrtni vijčani spoj
Oblik izrade	Kutevi 90°
Norma	DIN 2353 ISO 8434-1
Opseg isporuke	Nastavak (bez pretorne matice i nareznog prstena)
Materijal	Čelik
Površinska zaštita	galvanski premaz

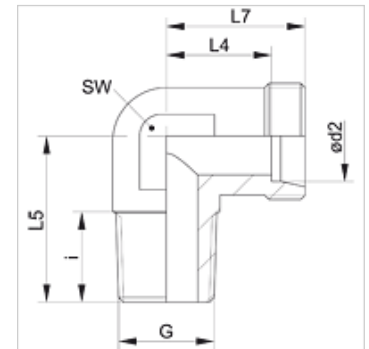

Napomena

Upute za montažu, ugradnju, tlačno opterećenje i dopuštene radne temperature pronaći ćete u tehničkim informacijama za vijčane spojeve cijevi.

Artikli

Naziv	Seriya	Radni tlak bari	Ø d2 (mm)	G	i (mm)	L4 (mm)	L5 (mm)	L7 (mm)	SW (mm)
XWM 04 LL	LL	PN 100	4	M 8 x 1 K	8,0	11,0	17	15	9
XWM 04 LL 6	LL	PN 100	4	M 6 x 1 K	8,0	11,0	17	15	9
XWM 05 LL	LL	PN 100	5	M 8 x 1 K	8,0	9,5	17	15	9
XWM 06 LL 6	LL	PN 100	6	M 6 x 1 K	7,0	9,5	17	15	9
XWM 06 LL 8	LL	PN 100	6	M 8 x 1 K	8,0	9,5	17	15	9
XWM 06 LL	LL	PN 100	6	M 10 x 1 K	9,0	9,5	17	15	9
XWM 08 LL	LL	PN 100	8	M 10 x 1 K	10,0	11,5	20	17	12
XWM NW 04 HL	L	PN 315	6	M 10 x 1 K	8,0	12,0	20	19	12
XWM NW 04 HL 12	L	PN 315	6	M 12 x 1,5 K	12,0	12,0	22	19	12
XWM NW 06 HL	L	PN 315	8	M 12 x 1,5 K	12,0	14,0	26	21	12
XWM NW 08 HL	L	PN 315	10	M 14 x 1,5 K	11,5	15,0	27	22	14
XWM NW 08 HL 16	L	PN 315	10	M 16 x 1,5 K	11,5	15,0	28	22	14
XWM NW 10 HL	L	PN 315	12	M 16 x 1,5 K	11,5	17,0	28	24	17
XWM NW 13 HL	L	PN 315	15	M 18 x 1,5 K	13,5	21,0	32	28	19
XWM NW 16 HL	L	PN 315	18	M 22 x 1,5 K	15,0	23,5	36	31	24
XWM NW 03 HS	S	PN 400	6	M 12 x 1,5 K	12,0	16,0	26	23	12
XWM NW 04 HS	S	PN 400	8	M 14 x 1,5 K	12,0	17,0	27	24	14
XWM NW 06 HS	S	PN 400	10	M 16 x 1,5 K	12,0	17,5	28	25	17
XWM NW 08 HS	S	PN 400	12	M 18 x 1,5 K	12,0	21,5	28	29	17
XWM NW 10 HS	S	PN 400	14	M 20 x 1,5 K	14,0	22,0	32	30	19
XWM NW 13 HS	S	PN 400	16	M 22 x 1,5 K	14,0	24,5	32	33	24

Seriya: LL = veoma lagan L = lagan S = težak – PN = nazivni tlak PB = maks. radni tlak – Ø d2 = vanjski promjer cijevi

Varijante proizvoda

XWMK VA	Uvrtni vijčani spoj, kut 90°, Oplemenjeni čelik
WMK	Uvrtni vijčani spoj, kut 90°, Čelik