

### Karakteristike

<b>Priključak 1</b>	NPT vanjski navoji
<b>Oblik brtve 1</b>	brtvljenje navoja
<b>Priključak 2</b>	metrički vanjski navoji, cilindrični
<b>Oblik brtve 2</b>	24° unutarnji konus
<b>Izvedba</b>	Uvrtni vijčani spoj
<b>Oblik izrade</b>	Kutevi 90°
<b>Norma</b>	DIN 2353 ISO 8434-1
<b>Opseg isporuke</b>	Nastavak (bez preturme matice i nareznog prstena)
<b>Materijal</b>	Čelik
<b>Površinska zaštita</b>	galvanski premaz

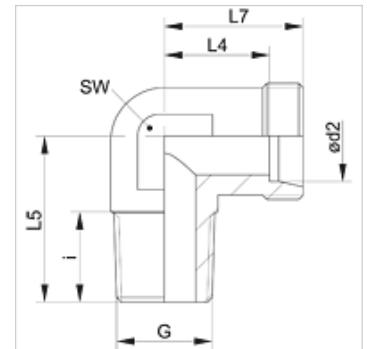

### Napomena

Upute za montažu, ugradnju, tlačno opterećenje i dopuštene radne temperature pronaći ćete u tehničkim informacijama za vijčane spojeve cijevi.

### Artikli

Naziv	Seriya	Radni tlak bari	Vanjski Ø cijevi (mm)	G	i (mm)	L4 (mm)	L5 (mm)	L7 (mm)	SW (mm)
XWN 04 LL	LL	PN 100	4	1/8" -27 NPT	8,0	11,0	17	15,0	9
XWN 05 LL	LL	PN 100	5	1/8" -27 NPT	8,0	11,0	17	15,0	9
XWN 06 LL	LL	PN 100	6	1/8" -27 NPT	8,0	9,5	17	15,0	9
XWN 08 LL	LL	PN 100	8	1/8" -27 NPT	10,0	11,5	20	17,0	12
XWN NW 04 HL	L	PN 315	6	1/8" -27 NPT	10,0	12,0	20	19,0	12
XWN NW 04 HL 1/4	L	PN 315	6	1/4" - 18 NPT	12,0	14,0	26	21,0	12
XWN NW 04 HL 1/2	L	PN 315	6	1/2" - 14 NPT	17,0	23,0	34	30,0	19
XWN NW 06 HL	L	PN 315	8	1/4" - 18 NPT	12,0	14,0	26	21,0	12
XWN NW 06 HL 3/8	L	PN 315	8	3/8" - 18 NPT	15,2	11,5	20	18,5	12
XWN NW 06 HL 1/2	L	PN 315	8	1/2" - 14 NPT	17,5	15,0	26	22,0	12
XWN NW 08 HL	L	PN 315	10	1/4" - 18 NPT	14,0	15,0	27	22,0	14
XWN NW 08 HL 3/8	L	PN 315	10	3/8" - 18 NPT	15,2	15,0	27	22,0	14
XWN NW 10 HL	L	PN 315	12	3/8" - 18 NPT	12,5	17,0	28	24,0	17
XWN NW 10 HL 1/4	L	PN 315	12	1/4" - 18 NPT	14,0	17,0	28	24,0	17
XWN NW 10 HL 1/2	L	PN 315	12	1/2" - 14 NPT	19,0	23,0	34	30,0	19
XWN NW 13 HL	L	PN 315	15	1/2" - 14 NPT	18,5	21,0	34	28,0	19
XWN NW 13 HL 3/8	L	PN 315	15	3/8" - 18 NPT	13,0	21,0	34	28,0	19
XWN NW 16 HL	L	PN 315	18	1/2" - 14 NPT	20,0	23,5	36	31,0	24
XWN NW 16 HL 3/4	L	PN 315	18	3/4" - 14 NPT	18,5	23,5	40	31,0	24
XWN NW 20 HL	L	PN 160	22	3/4" - 14 NPT	18,5	27,5	42	35,0	27
XWN NW 25 HL	L	PN 160	28	1" -11,5 NPT	24,0	30,5	48	38,0	36
XWN NW 32 HL	L	PN 160	35	1,1/4" - 11,5 NPT	25,5	34,5	54	45,0	41
XWN NW 40 HL	L	PN 160	42	1,1/2" - 11,5 NPT	26,0	40,0	61	51,0	50
XWN NW 03 HS	S	PN 630	6	1/4" - 18 NPT	12,0	16,0	26	23,0	12
XWN NW 04 HS	S	PN 630	8	1/4" - 18 NPT	15,0	17,0	27	24,0	14
XWN NW 06 HS	S	PN 630	10	3/8" - 18 NPT	12,0	17,5	28	25,0	17
XWN NW 08 HS	S	PN 630	12	3/8" - 18 NPT	12,5	21,5	28	29,0	17
XWN NW 10 HS	S	PN 630	14	1/2" - 14 NPT	18,0	22,0	34	30,0	19
XWN NW 13 HS	S	PN 400	16	1/2" - 14 NPT	19,0	24,5	36	33,0	24
XWN NW 13 HS 3/4	S	PN 400	16	3/4" - 14 NPT	20,0	24,5	40	33,0	24
XWN NW 16 HS	S	PN 400	20	3/4" - 14 NPT	20,0	26,6	42	37,0	27
XWN NW 20 HS	S	PN 400	25	1" -11,5 NPT	24,0	30,0	48	42,0	36
XWN NW 25 HS	S	PN 400	30	1,1/4" - 11,5 NPT	25,5	35,5	54	49,0	41
XWN NW 32 HS	S	PN 315	38	1,1/2" - 11,5 NPT	26,0	41,0	61	57,0	50

Seriya: LL = veoma lagan L = lagan S = težak - PN = nazivni tlak PB = maks. radni tlak - Ø d2 = vanjski promjer cijevi

### Varijante proizvoda

<b>XWN VA</b>	Uvrtni vijčani spoj, kut 90°, Oplemenjeni čelik
<b>WN</b>	Uvrtni vijčani spoj, kut 90°, Čelik