

Karakteristike

| | |
|---------------------------|--------------------|
| Priključak 1 | NPT vanjski navoji |
| Oblik brtve 1 | brtvljenje navoja |
| Priključak 2 | NPT vanjski navoji |
| Oblik brtve 2 | brtvljenje navoja |
| Izvedba | Spojni nastavci |
| Oblik izrade | ravno |
| Materijal | Čelik |
| Površinska zaštita | galvanski premaz |

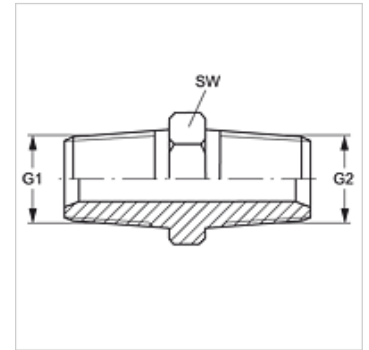

Artikli

| Naziv | G1 | G2 | SW (mm) |
|-------------------|-------------------|-------------------|------------|
| G HN 02 | 1/8" -27 NPT | 1/8" -27 NPT | 11 |
| G 04 HN 02 | 1/4" - 18 NPT | 1/8" -27 NPT | 14 |
| G HN 04 | 1/4" - 18 NPT | 1/4" - 18 NPT | 14 |
| G 06 HN 02 | 3/8" - 18 NPT | 1/8" -27 NPT | 19 |
| G 06 HN 04 | 3/8" - 18 NPT | 1/4" - 18 NPT | 19 |
| G HN 06 | 3/8" - 18 NPT | 3/8" - 18 NPT | 19 |
| G 08 HN 04 | 1/2" - 14 NPT | 1/4" - 18 NPT | 22 |
| G 08 HN 06 | 1/2" - 14 NPT | 3/8" - 18 NPT | 22 |
| G HN 08 | 1/2" - 14 NPT | 1/2" - 14 NPT | 22 |
| G 12 HN 04 | 3/4" - 14 NPT | 1/4" - 18 NPT | 27 |
| G 12 HN 06 | 3/4" - 14 NPT | 3/8" - 18 NPT | 27 |
| G 12 HN 08 | 3/4" - 14 NPT | 1/2" - 14 NPT | 27 |
| G HN 12 | 3/4" - 14 NPT | 3/4" - 14 NPT | 27 |
| G 12 HN 16 | 3/4" - 14 NPT | 1" -11,5 NPT | 36 |
| G 16 HN 08 | 1" -11,5 NPT | 1/2" - 14 NPT | 36 |
| G HN 16 | 1" -11,5 NPT | 1" -11,5 NPT | 36 |
| G 20 HN 16 | 1,1/4" - 11,5 NPT | 1" -11,5 NPT | 46 |
| G HN 20 | 1,1/4" - 11,5 NPT | 1,1/4" - 11,5 NPT | 46 |
| G 24 HN 08 | 1,1/2" - 11,5 NPT | 1/2" - 14 NPT | 50 |
| G 24 HN 16 | 1,1/2" - 11,5 NPT | 1" -11,5 NPT | 50 |
| G 24 HN 20 | 1,1/2" - 11,5 NPT | 1,1/4" - 11,5 NPT | 50 |
| G HN 24 | 1,1/2" - 11,5 NPT | 1,1/2" - 11,5 NPT | 50 |
| G 32 HN 24 | 2" -11,5 NPT | 1,1/2" - 11,5 NPT | 65 |
| G HN 32 | 2" -11,5 NPT | 2" -11,5 NPT | 65 |
| G HN 40 | 2,1/2" - 8 NPT | 2,1/2" - 8 NPT | 70 |

SW = širina ključa

Varijante proizvoda

G HN VA Spojni nastavci, Oplemenjeni čelik