

## Karakteristike

<b>Brzina klizanja max.</b>	5,0 m/s
<b>Površinsko pritiskanje</b>	na 20°C 15 N/mm <sup>2</sup> ; na 100°C 10 N/mm <sup>3</sup>
<b>Temperatura min.</b>	-30 °C
<b>Temperatura max.</b>	110 °C
<b>Mediji</b>	Mineralna ulja Emulzije vode
<b>Montaža</b>	umetnuti u utor
<b>Materijal</b>	acetat smola + staklena vlakna

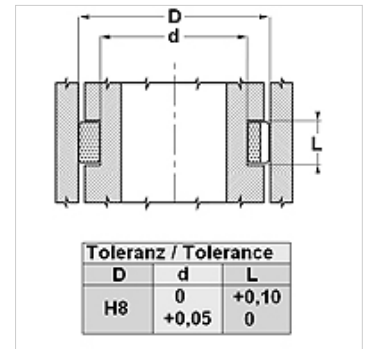
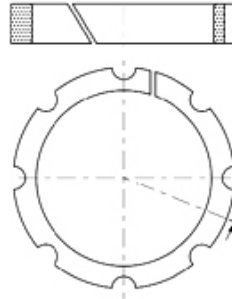

## Napomena

Izračun poprečne sile;  $F = p \times D \times L \times n$

F= maksimalna poprečna sila (N)

p= Maksimalno površinsko prešanje (N/mm<sup>2</sup>)

D x L= projicirana površina (mm<sup>2</sup>)

n= broj prstena

## Opis

jednostavna obrada i montaža ugradnog utora

Visoka nosivost za plunger cilindre.

Pozor, ne može se upotrijebiti kao graničnik

## Artikli

Naziv	D (mm)	d (mm)	L (mm)
WP 25	25	15	10,0
WP 30	30	20	13,0
WP 35	35	25	13,0
WP 40	40	30	13,0
WP 45	45	35	13,0
WP 55	55	45	16,0
WP 60	60	45	16,0
WP 65	65	55	16,0
WP 75	75	65	16,0
WP 85	85	75	16,0