

## Karakteristike

|                      |   |
|----------------------|---|
| Izvedba              | Strugač   |
| Brzina klizanja max. | 0,5 m/s   |
| Temperatura min.     | -30 °C  |
| Temperatura max.     | 110 °C  |
| Mediji               | Mineralna ulja<br>Emulzije vode                                 |
| Montaža              | Strugač oblikovati u obliku bubrega i utisnuti u prihvatni utor |
| Materijal            | 90° Shore A NBR   |
| Primjena             | Hidraulika  |

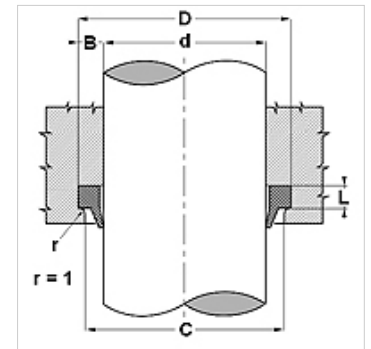

| Toleranz / Tolerance |            |            |            |
|----------------------|------------|------------|------------|
| d                    | D          | L          | C          |
| h11                  | +0,20<br>0 | +0,10<br>0 | +0,20<br>0 |



## Opis

jednostavna montaža  
jednostavno rješenje.  
potrebno malo mjesta

## Napomene uz narudžbu

Moguć je i drugi materijal: FPM.

## Artikli

| Naziv       | d<br>(mm) | D<br>(mm) | L<br>(mm) | C<br>(mm) |
|-------------|-----------|-----------|-----------|-----------|
| WRM 470 70  | 12,0      | 18,6      | 3,8       | 15,0      |
| WRM 590 82  | 15,0      | 21,6      | 3,8       | 18,0      |
| WRM 620 87  | 16,0      | 22,6      | 3,8       | 19,0      |
| WRM 700 94  | 18,0      | 24,6      | 3,8       | 21,0      |
| WRM 781 10  | 20,0      | 28,6      | 5,3       | 23,0      |
| WRM 861 18  | 22,0      | 30,6      | 5,3       | 25,0      |
| WRM 981 29  | 25,0      | 33,6      | 5,3       | 28,0      |
| WRM 102 133 | 26,0      | 34,6      | 5,3       | 29,0      |
| WRM 106 137 | 27,0      | 35,6      | 5,3       | 30,0      |
| WRM 110 141 | 28,0      | 36,6      | 5,3       | 31,0      |
| WRM 118 149 | 30,0      | 38,6      | 5,3       | 33,0      |
| WRM 125 157 | 32,0      | 40,6      | 5,3       | 35,0      |
| WRM 137 169 | 35,0      | 43,6      | 5,3       | 38,0      |
| WRM 141 173 | 36,0      | 44,6      | 5,3       | 39,0      |
| WRM 157 188 | 40,0      | 48,6      | 5,3       | 43,0      |
| WRM 165 196 | 42,0      | 50,6      | 5,3       | 45,0      |
| WRM 177 208 | 45,0      | 53,6      | 5,3       | 48,0      |
| WRM 177 216 | 45,0      | 55,6      | 5,3       | 49,0      |
| WRM 196 228 | 50,0      | 58,6      | 5,3       | 53,0      |
| WRM 196 236 | 50,0      | 60,6      | 5,3       | 54,0      |
| WRM 216 248 | 55,0      | 63,6      | 5,3       | 58,0      |
| WRM 220 251 | 56,0      | 64,6      | 5,3       | 59,0      |
| WRM 220 259 | 56,0      | 66,6      | 5,3       | 60,0      |
| WRM 236 267 | 60,0      | 68,6      | 5,3       | 63,0      |
| WRM 248 279 | 63,0      | 71,6      | 5,3       | 66,0      |
| WRM 255 287 | 65,0      | 73,6      | 5,3       | 68,0      |
| WRM 255 295 | 65,0      | 75,6      | 5,3       | 69,0      |
| WRM 275 307 | 70,0      | 78,6      | 5,3       | 73,0      |
| WRM 275 314 | 70,0      | 80,6      | 5,3       | 74,0      |
| WRM 275 322 | 70,0      | 82,2      | 7,1       | 76,0      |
| WRM 283 317 | 72,0      | 80,6      | 5,3       | 75,0      |
| WRM 295 345 | 75,0      | 87,2      | 7,1       | 81,0      |
| WRM 301 348 | 76,5      | 88,7      | 7,1       | 82,5      |
| WRM 307 362 | 78,0      | 92,2      | 7,1       | 85,0      |
| WRM 314 346 | 80,0      | 88,6      | 5,3       | 83,0      |
| WRM 314 362 | 80,0      | 92,2      | 7,1       | 86,0      |
| WRM 334 366 | 85,0      | 93,6      | 5,3       | 88,0      |
| WRM 346 393 | 88,0      | 100,2     | 7,1       | 94,0      |
| WRM 354 401 | 90,0      | 102,2     | 7,1       | 96,0      |



## Artikli

| Naziv          | d<br>(mm) | D<br>(mm) | L<br>(mm) | C<br>(mm) |
|----------------|-----------|-----------|-----------|-----------|
| WRM 374 421    | 95,0      | 107,2     | 7,1       | 101,0     |
| WRM 393 440    | 100,0     | 112,2     | 7,1       | 106,0     |
| WRM 413 460    | 105,0     | 117,2     | 7,1       | 111,0     |
| WRM 433 480    | 110,0     | 122,2     | 7,1       | 116,0     |
| WRM 452 500    | 115,0     | 127,2     | 7,1       | 121,0     |
| WRM 472 504    | 120,0     | 128,0     | 7,0       | 123,0     |
| WRM 472 519    | 120,0     | 132,2     | 7,1       | 126,0     |
| WRM 492 539    | 125,0     | 137,2     | 7,1       | 131,0     |
| WRM 492 551    | 125,0     | 140,2     | 10,1      | 132,0     |
| WRM 531 578    | 135,0     | 147,2     | 7,1       | 141,0     |
| WRM 551 598    | 140,0     | 152,2     | 7,1       | 146,0     |
| WRM 551 610    | 140,0     | 155,2     | 10,1      | 147,0     |
| WRM 570 618    | 145,0     | 157,2     | 7,1       | 151,0     |
| WRM 590 637    | 150,0     | 162,2     | 7,1       | 156,0     |
| WRM 629 661    | 160,0     | 168,6     | 5,3       | 163,0     |
| WRM 629 688    | 160,0     | 175,2     | 10,1      | 168,0     |
| WRM 673 720    | 171,0     | 183,0     | 6,3       | 176,0     |
| WRM 688 744    | 175,0     | 189,2     | 7,1       | 182,0     |
| WRM 708 767    | 180,0     | 195,0     | 10,1      | 188,0     |
| WRM 708 787    | 180,0     | 200,0     | 10,1      | 190,0     |
| WRM 787 847    | 200,0     | 215,0     | 10,1      | 207,0     |
| WRM 787 866    | 200,0     | 220,0     | 10,1      | 210,0     |
| WRM 102 411 02 | 260,0     | 280,0     | 10,2      | 270,0     |