

# K-VAKUUMSCHALTER

Vacuum switch

**HANSA FLEX**

## Karakteristike

Priključak za mjerni medij	G 1/8 male and M 5 female
Izlazni signal	Analogue: 1 to 5 V
Električni priključak	Male connector M8, four pin
Histereza	Adjustable: 3 to 25% of set value
Mediji	Non-aggressive gases. dry, oil-free air
Uklopna funkcija	PNP
Uklopni kapacitet	125 mA
Potrošnja struje	30 mA
Temperaturno područje	0 - 50 °C
Kućište	Polycarbonate

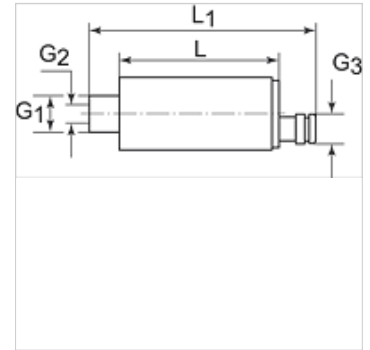

## Napomena

Drugi podatci na zahtjev.

## Opis

Universal electronic vacuum switch for safety monitoring, optimisation of cycle times and regulation circuits. Its small size and low weight permit installation directly on the suction pad. <br>Switching point and hysteresis adjustable with a screw. Integrated LED for indication of the switching state.

## Artikli

Naziv	Vanjski navoj 1	Unutarnji navoj 2	Vanjski navoj 3	L (mm)	L1 (mm)	Mjerno područje	Napon
K- 07 45 01 58	G 1/8	M 5	M 8 x 1	44,0	62,0	-1 bis 0 bar	10.8 - 30 V DC