

# K-DRS ELK ANSCHLUSS M VAKUUM

Pressure switches, electrical connection M 12 x 1

**HANSA FLEX**

## Karakteristike

<b>Područje primjene</b>	Pneumatic applications
<b>Učestalost uklapanja</b>	200/min.
<b>Uklopni napon</b>	max. 250 V AC / 28 V DC
<b>Područje namještanja</b>	-0.85 / +1 bar
<b>Vrsta zaštite</b>	IP 65 (DIN 43650), IP 67 (M 12 x 1)
<b>Temperaturno područje</b>	-10 °C to +80 °C
<b>Čep za namještanje</b>	Aluminium, powder-coated
<b>Kućište</b>	Special die-cast material
<b>Membrana, brtva</b>	Perbunan

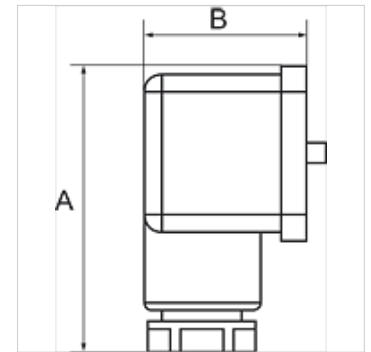

## Napomena

Drugi podatci na zahtjev.

## Opis

For converting pneumatic to electrical signals. Designed for use in rough vacuum applications (technical vacuum). Universal switch type, suitable as NC, NO or changeover contact. These devices are free from paint-wetting impairment substances (PWIS).

## Artikli

Naziv	Priključak	A (mm)	B (mm)
K- 07 30 28 52	Prirubnica	48,0	28,0
K- 07 30 28 54	G 1/4	48,0	28,0