

# K-MV G D 230 V, 50 - 60 HZ 1

Normally closed, directly operated, 230 V, 50 to 60 Hz

**HANSA FLEX**

## Karakteristike

|                         |   |
|-------------------------|---|
| Električni priključak   | For connector socket Pg 9/Pg 11, acc. to ISO 4400 |
| Vrsta zaštite           | IP65 (with connector socket fitted)               |
| Temperatura medija      | -10 °C to +90 °C (NBR); -10 °C bis +140 °C (FKM)  |
| Kućište, dosjed ventila | Brass   |
| Unutarnji dijelovi      | Stainless steel                                   |
| Brtva                   | Perbunan (NBR) or FKM                             |

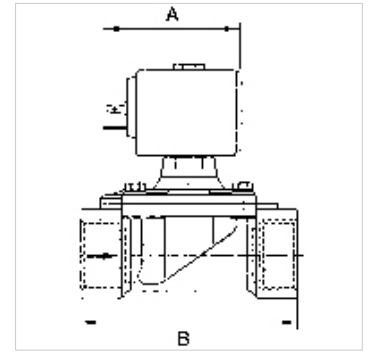
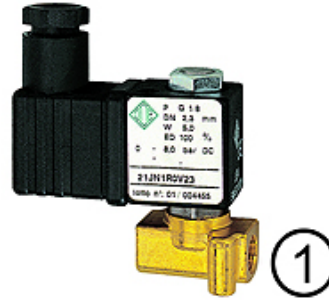

## Napomena

Drugi podatci na zahtjev.

## Opis

Economy series available in three different versions: Directly operated, Combined operation, Pilot-operated. For all applications with compressed air, neutral gases or low-viscosity, neutral media.

## Artikli

| Naziv          | Navoj | maks. radni tlak (bar) | Nazivni promjer | Brtveni materijal | A (mm) | B (mm) | Oblik izrade |
|----------------|-------|------------------------|-----------------|-------------------|--------|--------|--------------|
| K- 07 30 22 39 | G 1/8 | 18                     | 2,3             | FKM               | 41,0   | 30,0   | 1            |
| K- 07 30 22 40 | G 1/8 | 6                      | 2,3             | FKM               | 41,0   | 30,0   | 1            |
| K- 07 30 22 41 | G 1/8 | 14                     | 2,5             | FKM               | 54,0   | 40,0   | 2            |
| K- 07 30 22 42 | G 1/8 | 10                     | 3,0             | FKM               | 54,0   | 40,0   | 2            |
| K- 07 30 22 43 | G 1/4 | 14                     | 2,5             | FKM               | 54,0   | 40,0   | 2            |
| K- 07 30 22 44 | G 1/4 | 10                     | 3,0             | FKM               | 54,0   | 40,0   | 2            |
| K- 07 30 22 45 | G 1/4 | 5                      | 4,5             | FKM               | 54,0   | 40,0   | 2            |