

K-RD SCHRAEGSITZ VA

Unidirectional valves

HANSA FLEX

Karakteristike

Radni tlak	Max. 40 bar
Opis navoja	G thread acc. DIN EN ISO 228-1
Temperatura medija	max. +180 °C
Tlak otvaranja	min. 0.2 bar
Okolna temperatura	Max. +180 °C
Kućište, unutarnji dijelovi	Stainless Steel 1.4401/1.4408
Brtveni materijal	FKM

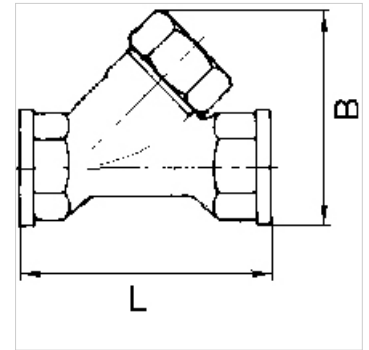

Napomena

Drugi podatci na zahtjev.

Artikli

Naziv	Navoj	B (mm)	L (mm)	SW (mm)
K- 07 30 24 67	G 1/4	53,5	66,0	27
K- 07 30 24 68	G 3/8	53,5	66,0	27
K- 07 30 24 69	G 1/2	53,5	66,0	27
K- 07 30 24 70	G 3/4	68,0	76,0	32
K- 07 30 24 71	G 1	82,0	90,0	40
K- 07 30 24 72	G 1 1/4	97,0	110,0	50
K- 07 30 24 73	G 1 1/2	113,0	121,0	55
K- 07 30 24 74	G 2	131,0	151,0	70