

K-W90 STUECK IG AG RP-GEW

90° elbows, female-male, female thread: Rp thread acc. to ISO 7-1,
male thread: R thread acc. to ISO 7-1

HANSA FLEX

Karakteristike

Radni tlak	maks. 20 bar
Radna temperatura	Max. 175 °C
Unutarnji navoj	Rp-thread acc. ISO 7-1
Materijal	Stainless steel 1.4401 / 1.4408
Vanjski navoj	R-thread acc. ISO 7-1

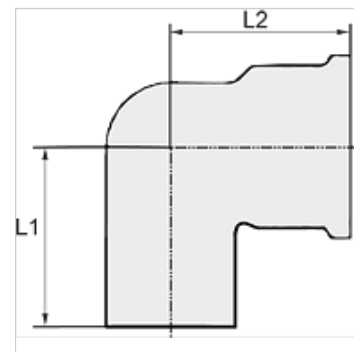

Napomena

Drugi podatci na zahtjev.

Artikli

Naziv	Navoj	L1 (mm)	L2 (mm)
K- 07 40 10 33	Rp 1/8 female, R 1/8 male	24,0	17,0
K- 07 40 10 34	Rp 1/4 female, R 1/4 male	28,0	20,0
K- 07 40 10 35	Rp 3/8 female, R 3/8 male	32,0	22,0
K- 07 40 10 36	Rp 1/2 female, R 1/2 male	38,0	27,0
K- 07 40 10 37	Rp 3/4 female, R 3/4 male	45,0	32,0
K- 07 40 10 38	Rp 1 female, R 1 male	52,0	37,0