

K-XV 6-KANT

Double nipples, hexagonal

HANSA FLEX

Karakteristike

Radni tlak	Max. 20 bar
Vanjski navoj	Parallel to DIN EN ISO 228-1
Materijal	Stainless steel 1.4408

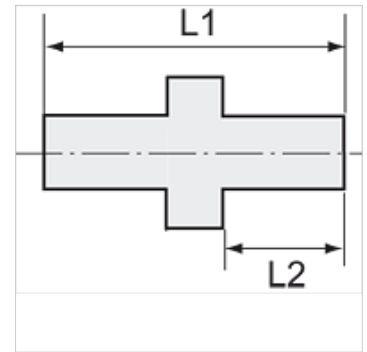

Napomena

The dimensions of the standard screw fittings may change slightly during the life of the catalogue as a result of optimisation processes.
Drugi podatci na zahtjev.

Artikli

Naziv	Navoj	L1 (mm)	L2 (mm)	SW (veličina ključa)
K- 07 40 12 18	G 1/8	30,0	12,0	13 mm
K- 07 40 12 19	G 1/4	32,0	13,0	16 mm
K- 07 40 12 20	G 3/8	34,0	13,0	20 mm
K- 07 40 12 21	G 1/2	37,5	15,0	24 mm
K- 07 40 12 22	G 3/4	46,0	18,0	29 mm
K- 07 40 12 23	G 1	51,0	19,0	35 mm
K- 07 40 12 24	G 1 1/4	57,0	22,0	46 mm
K- 07 40 12 25	G 1 1/2	58,0	23,0	51 mm
K- 07 40 12 26	G 2	66,9	26,0	63 mm