

# K-VSTOK 6

Plugs, hexagonal

**HANSA FLEX**

## Karakteristike

Radni tlak	Max. 20 bar
Vanjski navoj	Parallel to DIN EN ISO 228-1
Materijal	Stainless steel 1.4408

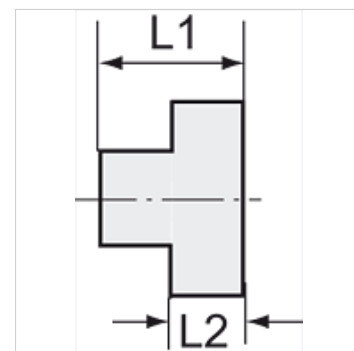

## Napomena

The dimensions of the standard screw fittings may change slightly during the life of the catalogue as a result of optimisation processes.  
Drugi podatci na zahtjev.

## Artikli

Naziv	Navoj	L1 (mm)	L2 (mm)	SW (veličina ključa)
K- 07 40 39 82	G 1/8	17,3	6,3	12 mm
K- 07 40 39 83	G 1/4	18,3	6,2	17 mm
K- 07 40 39 84	G 3/8	19,3	6,0	21 mm
K- 07 40 39 85	G 1/2	22,2	6,0	26 mm
K- 07 40 39 86	G 3/4	25,2	6,8	31 mm
K- 07 40 39 87	G 1	27,0	7,3	38 mm
K- 07 40 39 88	G 1 1/4	30,2	7,7	46 mm
K- 07 40 39 89	G 1 1/2	32,4	8,8	53 mm
K- 07 40 39 90	G 2	36,0	10,0	63 mm