

K-W90 VERSCHR HL

Union elbows, pipe connection on both sides

HANSA FLEX

Karakteristike

Područje tlaka Max. 60 bar

Temperatura Max. 150 °C

Materijal poniklani mjed

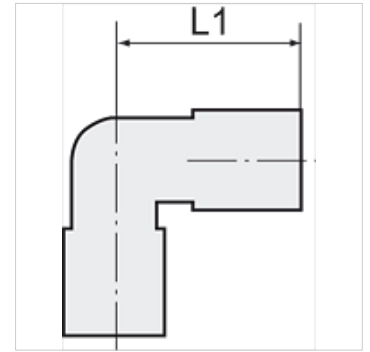

Napomena

Drugi podatci na zahtjev.

Artikl

Naziv	Vanjski Ø cijevi	L1 (mm)	SW (veličina ključa)	SW1 (mm)
K- 07 40 20 48	4 mm	21,0	9 mm	10
K- 07 40 20 52	12 mm	34,5	15 mm	22
K- 07 40 20 50	8 mm	24,0	11 mm	14
K- 07 40 20 51	10 mm	32,0	13 mm	19
K- 07 40 20 54	18 mm	44,0	22 mm	32
K- 07 40 20 53	15 mm	38,0	17 mm	27
K- 07 40 20 49	6 mm	23,0	9 mm	12