

K-SV 6 4

Bulkhead connectors

HANSA FLEX

Karakteristike

maks. radni tlak	18 bar
upotreblijiva crijeva	PA, PE, PU
Materijal	poniklani mjed

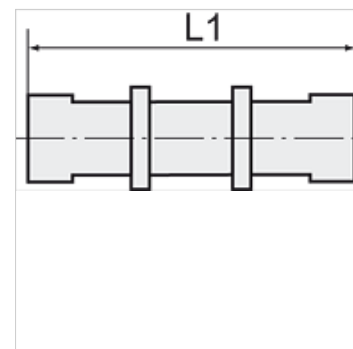
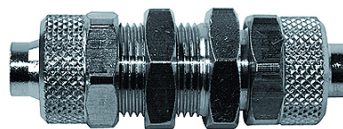

Napomena

Drugi podatci na zahtjev.

Artikl

Naziv	Navoj	za crijevo	L1 (mm)	SW (veličina ključa)
K- 07 40 33 82	M 10 x 1	6 mm / 4 mm	48,0	14 mm
K- 07 40 33 83	M 12 x 1	8 mm / 6 mm	48,0	16 mm