

K-W90 AG-K ISO 7-1 4

Male elbows, conical male thread, acc. to ISO 7-1

HANSA FLEX

Karakteristike

Radni tlak Max. 18 bar

Brtnveni materijal Buna-N

Materijal poniklani mjed

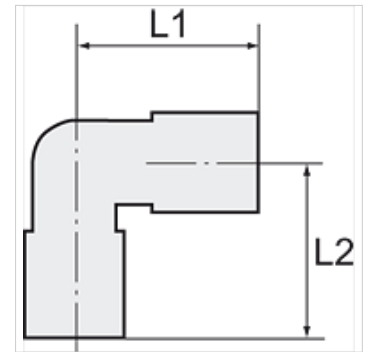

Napomena

Drugi podatci na zahtjev.

Artikli

Naziv	Navoj	za crijevo	L1 (mm)	L2 (mm)	SW (veličina ključa)
K- 07 40 31 34	R 1/8	4 mm / 2 mm	24,5	16,0	9 mm
K- 07 40 31 35	R 1/8	5 mm / 3 mm	21,5	17,0	8 mm
K- 07 40 31 36	R 1/8	6 mm / 4 mm	22,0	17,0	9 mm
K- 07 40 31 37	R 1/8	8 mm / 6 mm	22,0	17,0	12 mm
K- 07 40 31 33	R 1/8	10 mm / 8 mm	25,5	18,5	11 mm
K- 07 40 31 31	R 1/4	6 mm / 4 mm	22,0	20,0	9 mm
K- 07 40 31 32	R 1/4	8 mm / 6 mm	22,0	20,0	12 mm
K- 07 40 31 30	R 1/4	10 mm / 8 mm	25,0	21,0	12 mm
K- 07 40 31 40	R 3/8	6 mm / 4 mm	23,5	22,5	11 mm
K- 07 40 31 41	R 3/8	8 mm / 6 mm	23,0	21,5	12 mm
K- 07 40 31 38	R 3/8	10 mm / 8 mm	25,0	21,5	12 mm
K- 07 40 31 39	R 3/8	12 mm / 10 mm	31,0	24,0	14 mm
K- 07 40 31 29	R 1/2	8 mm / 6 mm	23,5	28,0	16 mm
K- 07 40 31 27	R 1/2	10 mm / 8 mm	28,5	26,0	17 mm
K- 07 40 31 28	R 1/2	12 mm / 10 mm	31,0	26,0	17 mm