

# K-VERBINDER 1

Unions

**HANSA FLEX**

## Karakteristike

Radni tlak Max. 18 bar

Brtnveni materijal Buna-N

Materijal poniklani mjed

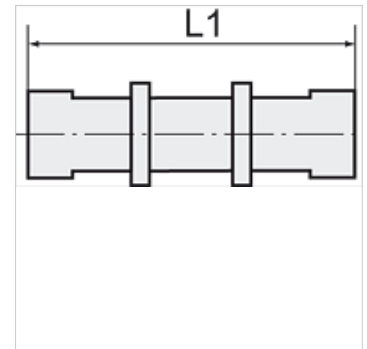
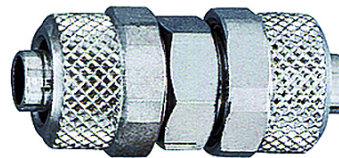

## Napomena

Drugi podatci na zahtjev.

## Artikl

Naziv	za crijevo	L1 (mm)	SW (veličina ključa)
K- 07 40 30 92	4 mm / 2 mm	41,0	10 mm
K- 07 40 30 93	5 mm / 3 mm	28,5	8 mm
K- 07 40 30 94	6 mm / 4 mm	33,0	12 mm
K- 07 40 30 95	8 mm / 6 mm	33,0	12 mm
K- 07 40 30 90	10 mm / 8 mm	37,0	14 mm
K- 07 40 30 91	12 mm / 10 mm	42,0	17 mm