

K-MUFFEN VALUE LINE MS NI

Sockets

HANSA FLEX

Karakteristike

| | |
|-------------------------|----------------|
| maks. radni tlak | 60 bar |
| maks. radna temperatura | 150 °C |
| Materijal | poniklani mjed |

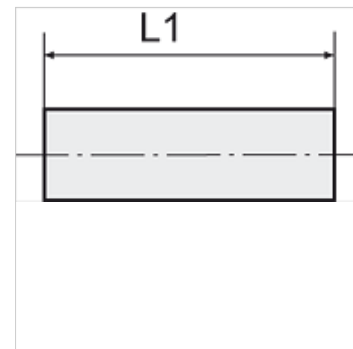

Napomena

The dimensions of the standard screw fittings may change slightly during the life of the catalogue as a result of optimisation processes.
Drugi podatci na zahtjev.

Opis

For air, water, steam, oil, etc.

Artikli

| Naziv | Navoj | L1 (mm) | SW (veličina ključa) |
|----------------|-------|------------|----------------------|
| K- 07 40 15 16 | M 5 | 11,0 | 8 mm |
| K- 07 40 15 17 | G 1/8 | 15,0 | 14 mm |
| K- 07 40 15 18 | G 1/4 | 22,0 | 17 mm |
| K- 07 40 15 19 | G 3/8 | 23,0 | 22 mm |
| K- 07 40 15 20 | G 1/2 | 28,0 | 26 mm |
| K- 07 40 15 21 | G 3/4 | 32,0 | 32 mm |