

K-FI MIKRO METALLBEHAEL MULTIFIX MI

Micro-filters with metal bowl

HANSA FLEX

Karakteristike

Ulazni tlak	Max. 16 bar
Temperatura medija	max. 60 °C
Okolna temperatura	Max. 60 °C
Finoća filtra	0,01 µm
Učinkovitost	99.999 %
Brtnveni materijal	NBR
Filtarski uložak	Borosilicate-POM
Kućište	Die-cast zinc
Drain valve	Semi-automatic
Mjerenje vrijednosti protoka	FM at P1 = 6 bar and pressure drop $\Delta p = 0.09$ bar

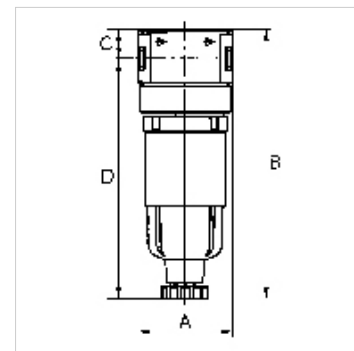

Napomena

If several devices in the »multifix-mini« Series are assembled together, the maximum working pressure is 12 bar.

Drugi podatci na zahtjev.

Opis

Micro-filters for compliance with strict compressed air purity requirements. Suitable for all applications where standard filters do not afford the desired efficiency.

Artikli

Naziv	Navoj	Protok (L/min)	A (mm)	B	C (mm)	D (mm)	DN
K- 07 25 10 55	G 1/8	230	40,0	111,6 mm	12,3	99,3	5
K- 07 25 10 57	G 1/4	450	40,0	138,1 mm	12,3	125,8	5

Rezervni dijelovi

K-AUTOMAT ABLASSVENTIL	Automatic drain valve
K-KOPPELPAKET MEHR	Coupling packet