

K-MV G (NC) D 24 V DC STA

Normally closed, (NC), directly operated, 24 V DC, standard type

HANSA FLEX

Karakteristike

Električni priključak	device socket type A in acc. with ISO 4400 for all valves with threads G 3/8 & G 1/2, except valves type 3 & 4. Device socket
Opis navoja	G thread acc. DIN EN ISO 228-1
Temperatura medija	max. 80 °C when using water or oils; max. 90 °C when using with air
Vrsta zaštite	IP 65
maks. radni tlak	10 bar
Brtveni materijal	FPM
Kučište, dosjed ventila	Stainless steel 1.4301
Unutarnji dijelovi	Stainless steel

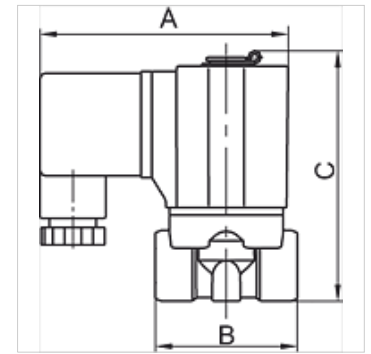

Napomena

Drugi podatci na zahtjev.

Opis

Standard series in two different versions: Directly operated, Pilot-operated

Artikli

Naziv	Navoj	Nazivni promjer	A (mm)	B (mm)	C (mm)	Oblik izrade
K- 07 30 01 20	G 1/8	3,0	70,0	40,0	70,7	1
K- 07 30 01 21	G 1/4	3,0	70,0	40,0	70,7	1
K- 07 30 01 22	G 3/8	5,0	85,0	52,0	87,0	1
K- 07 30 01 23	G 1/2	5,0	85,0	52,0	87,0	1