

# K-L-STECK STECKNIPPEL VB MINI

Union elbows with push-in plug, mini

**HANSA FLEX**

## Karakteristike

|                       |                              |
|-----------------------|------------------------------|
| Radni tlak            | Max. 10 bar, vacuum          |
| Područje primjene     | Air, vacuum                  |
| preporučena crijeva   | PU or PA (nylon)             |
| Mediji                | komprimirani zrak            |
| Temperaturno područje | 0 °C to +60 °C               |
| Materijal             | Plastic, Nickel plated brass |
| Pritisni prsten       | Plastic                      |

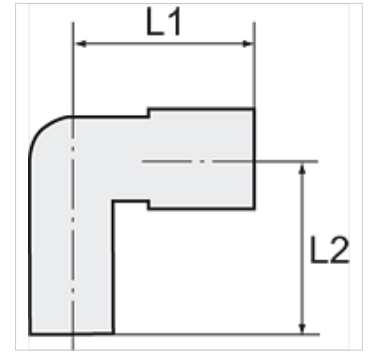

## Napomena

Drugi podatci na zahtjev.

## Opis

Push-in fittings series manufactured in plastic and nickel-plated brass, space-saving miniature design.

## Artikli

| Naziv          | za vanjski Ø crijeva | L1<br>(mm) | L2<br>(mm) | Utična nazuvica<br>(mm) |
|----------------|----------------------|------------|------------|-------------------------|
| K- 07 40 50 07 | 3 mm                 | 11,5       | 26,6       | 3                       |
| K- 07 40 50 08 | 4 mm                 | 14,0       | 28,5       | 4                       |
| K- 07 40 50 09 | 6 mm                 | 16,3       | 32,0       | 6                       |