

# K-W90 SCHLAUCH VB PFA

Elbow hose connectors - Perfluoroalkoxy alkane (PFA)

**HANSA FLEX**

## Karakteristike

<b>Radni tlak</b>	Dependent on operating temperature; Max. 10 bar (at 20 °C); Max. 1 bar (at 170 °C)
<b>Radna temperatura</b>	Max. 200 °C
<b>Materijal</b>	Perfluoroalkoxy alkane (PFA)

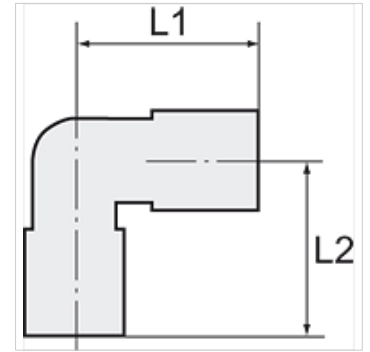

## Napomena

Drugi podatci na zahtjev.

## Opis

Perfluoroalkoxy alkane (PFA): A fluoroplastic (PTFE) with the same chemical resistance as PTFE but much stronger and suitable for temperatures up to 200°C.

## Artikli

Naziv	za crijevo	L1 (mm)	L2 (mm)
K- 07 40 41 58	4 mm / 6 mm	25,0	25,0
K- 07 40 41 60	6 mm / 8 mm	30,0	30,0
K- 07 40 41 62	8 mm / 10 mm	36,0	36,0