

K-W90 SCHLAUCH VB POLYPROPYPY

Elbow hose connectors - polypropylene

HANSA FLEX

Karakteristike

Radni tlak	Dependent on operating temperature; Max. 10 bar (at 20 °C); Max. 2.5 bar (at 90 °C)
Materijal	Polypropylene (PP)
Radna temperatura	Max. 90 °C

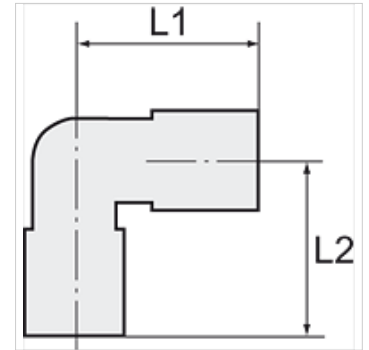

Napomena

Drugi podatci na zahtjev.

Opis

Chemically resistant to almost all inorganic acids and bases, even in high concentrations and at temperatures greater than 90 °C.

Artikli

Naziv	za crijevo	L1 (mm)	L2 (mm)
K- 07 40 41 57	4 mm / 6 mm	25,0	25,0
K- 07 40 41 59	6 mm / 8 mm	30,0	30,0
K- 07 40 41 61	8 mm / 10 mm	36,0	36,0
K- 07 40 41 63	9 mm / 12 mm	43,0	43,0