

K-L-STECKVER DREH AG OR

Male elbows, swivel type, parallel male thread with O-ring

HANSA FLEX

Karakteristike

Radni tlak	Max. 16 bar
Radna temperatura	-20 °C to +80 °C
Materijal	poniklani mjed
Pritisni prsten	Hostaform
O prsten	NBR
Stezni prsten	Stainless steel

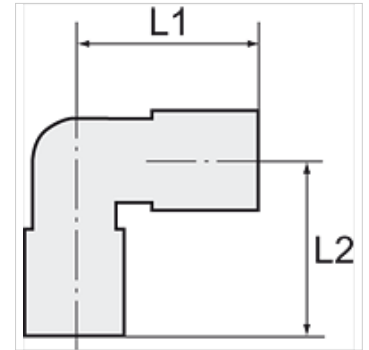

Napomena

Drugi podatci na zahtjev.

Opis

The advanced version of our highly successful push-in fittings series manufactured in nickel-plated brass. Advantages of this new, optimised series: Much easier connection and disconnection of the hose, even with repeated mounting, can also be used for non-calibrated hoses, suitable for vacuum operation.

Artikli

Naziv	Navoj	za vanjski Ø crijeva	L1 (mm)	L2 (mm)	SW (veličina ključa)
K- 07 40 25 68	M 5	4 mm	18,6	15,3	9 mm
K- 07 40 25 69	M 5	5 mm	22,8	15,3	9 mm
K- 07 40 25 70	M 5	6 mm	21,9	15,3	9 mm
K- 07 40 25 79	G 1/8	4 mm	18,6	19,1	12 mm
K- 07 40 25 80	G 1/8	5 mm	22,8	19,1	12 mm
K- 07 40 25 81	G 1/8	6 mm	21,9	19,1	12 mm
K- 07 40 25 82	G 1/8	8 mm	25,4	19,1	12 mm
K- 07 40 25 75	G 1/4	4 mm	18,6	21,1	14 mm
K- 07 40 25 76	G 1/4	5 mm	22,8	21,8	14 mm
K- 07 40 25 77	G 1/4	6 mm	21,9	21,1	14 mm
K- 07 40 25 78	G 1/4	8 mm	25,4	21,1	14 mm
K- 07 40 25 74	G 1/4	10 mm	27,2	24,8	14 mm
K- 07 40 47 20	G 1/4	12 mm	30,0	25,6	14 mm
K- 07 40 25 85	G 3/8	8 mm	23,6	27,1	17 mm
K- 07 40 25 83	G 3/8	10 mm	27,2	27,1	17 mm
K- 07 40 25 84	G 3/8	12 mm	30,0	27,1	17 mm
K- 07 40 25 71	G 1/2	10 mm	27,2	30,7	22 mm
K- 07 40 25 72	G 1/2	12 mm	30,0	30,7	22 mm
K- 07 40 25 73	G 1/2	14 mm	33,0	32,3	22 mm