

K-DRV STECK

Unidirectional flow control valves with plug connection, straight type

HANSA FLEX

Karakteristike

| | |
|-----------------------|--|
| Radni tlak | Max. 15 bar, coarse vacuum |
| Područje primjene | Air, vacuum |
| preporučena crijeva | PU or PA (nylon) |
| Mediji | Compressed air and all gases or liquids that are compatible with the materials |
| Temperaturno područje | -20 °C to +80 °C |
| Brtvena površina | Parallel version: O-ring in housing, Conical version: thread coating |
| Materijal | Plastic, Nickel plated brass |
| Pritisni prsten | Plastic |

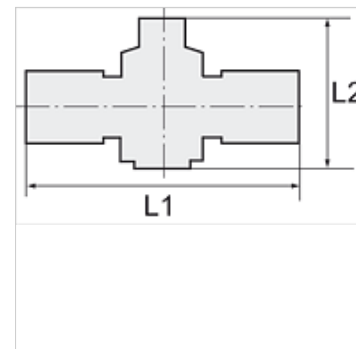

Napomena

Drugi podatci na zahtjev.

Opis

Push-in fittings series manufactured in plastic and nickel-plated brass. All parts are suitable for use with hoses, tubes or pipes made of plastic and copper.

Artikli

| Naziv | za vanjski Ø crijeva | L1 (mm) | L2 min. (mm) | L2 maks. (mm) |
|----------------|----------------------|------------|-----------------|------------------|
| K- 07 40 06 76 | 4 mm | 39,5 | 28,3 | 30,8 |
| K- 07 40 06 77 | 6 mm | 47,1 | 41,0 | 47,2 |
| K- 07 40 06 78 | 8 mm | 52,0 | 44,4 | 51,5 |
| K- 07 40 06 79 | 10 mm | 62,3 | 48,0 | 55,0 |
| K- 07 40 06 80 | 12 mm | 73,6 | 52,3 | 57,7 |