

K-SCHLAUCH VB POLYPROP

Hose connectors - polypropylene

HANSA FLEX

Karakteristike

Radni tlak	Dependent on operating temperature; Max. 10 bar (at 20 °C); Max. 2.5 bar (at 90 °C)
Materijal	Polypropylene (PP)
Radna temperatura	Max. 90 °C

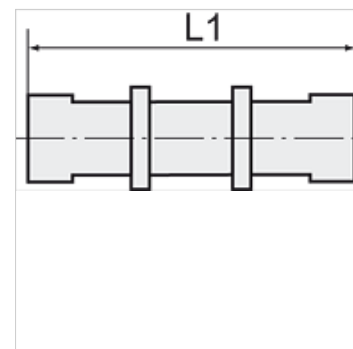
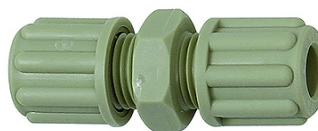

Napomena

Drugi podatci na zahtjev.

Opis

Chemically resistant to almost all inorganic acids and bases, even in high concentrations and at temperatures greater than 90 °C.

Artikli

Naziv	za crijevo	L1 (mm)	SW (veličina ključa)
K- 07 40 41 47	4 mm / 6 mm	39,0	14 mm
K- 07 40 41 51	6 mm / 8 mm	49,0	19 mm
K- 07 40 41 53	8 mm / 10 mm	55,0	22 mm
K- 07 40 41 55	9 mm / 12 mm	64,0	24 mm