

K-XG LOESBAR IG IG KONISCHDICH

Detachable double nipples, female, taper seat

HANSA FLEX

Tulajdonságok

| | |
|-------------|------------------------------|
| Munkanyomás | Max. 10 bar |
| Menet külső | Parallel to DIN EN ISO 228-1 |
| belső menet | Parallel to DIN EN ISO 228-1 |
| Anyag | Stainless steel 1.4408 |

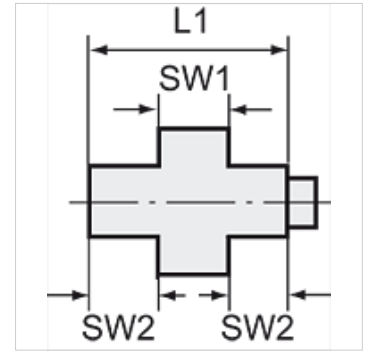

Megjegyzés

The dimensions of the standard screw fittings may change slightly during the life of the catalogue as a result of optimisation processes.
További adatokért vegye fel a kapcsolatot.

Cikk

| Megnevezés | Menet | L1 (mm) | SW1 (mm) | SW2 (mm) |
|----------------|---------|------------|-------------|-------------|
| K- 07 40 12 42 | G 1/8 | 32,3 | 29 | 18 |
| K- 07 40 12 43 | G 1/4 | 32,4 | 29 | 18 |
| K- 07 40 12 44 | G 3/8 | 34,7 | 34 | 22 |
| K- 07 40 12 45 | G 1/2 | 40,0 | 39 | 26 |
| K- 07 40 12 46 | G 3/4 | 42,0 | 47 | 32 |
| K- 07 40 12 47 | G 1 | 48,7 | 58 | 40 |
| K- 07 40 12 48 | G 1 1/4 | 54,0 | 67 | 49 |
| K- 07 40 12 49 | G 1 1/2 | 58,9 | 76 | 56 |
| K- 07 40 12 50 | G 2 | 62,2 | 90 | 68 |