

# K-HS RD

Unidirectional banjo valves, pneumatic release, port 2 with female thread

**HANSA FLEX**

## Tulajdonságok

|                          |  |
|--------------------------|--|
| <b>Munkanyomás</b>       | 0.3 - 10 bar   |
| <b>Vezérlőnyomás</b>     | 0.5 - 2.5 bar, depending on operating pressure                       |
| <b>Közeghőmérséklet</b>  | max. 60 °C   |
| <b>Beépítés helyzete</b> | Any. The ring piece must be positioned before the valve is tightened |
| <b>Anyag</b>             | Sárgaréz, nikkelezett  |
| <b>Tömítő anyag</b>      | Perbunan   |

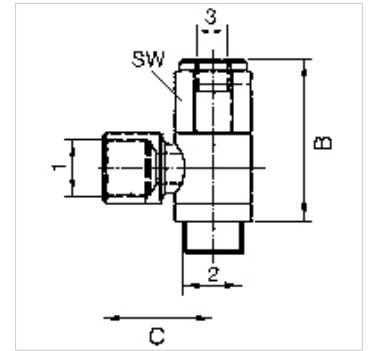

## Megjegyzés

További adatokért vegye fel a kapcsolatot.

## Leírás

For stopping and positioning the cylinder movement: If a control signal is present at port 3 (see drawing), air can flow to and from the cylinder. If no control signal is present, the cylinder exhaust air is shut off by the unidirectional valve. The cylinder is stopped. Releasable unidirectional valves are screwed directly onto the cylinder instead of the normal pipe connections.

## Cikk

| Megnevezés     | Port 1 | Port 2 | 3 csatlakozás | B<br>(mm) | C<br>(mm) |
|----------------|--------|--------|---------------|-----------|-----------|
| K- 07 15 07 04 | G 1/8  | G 1/8  | M 5           | 38,0      | 21,5      |
| K- 07 15 07 03 | G 1/4  | G 1/4  | G 1/8         | 43,0      | 25,4      |
| K- 07 15 07 05 | G 3/8  | G 3/8  | G 1/8         | 46,0      | 31,6      |
| K- 07 15 07 02 | G 1/2  | G 1/2  | G 1/8         | 52,0      | 32,0      |