

# K-RD STUECKE PP

Reducers

**HANSA FLEX**

## Tulajdonságok

Munkanyomás on request

Üzemi hőmérséklet Max. +20 °C

Anyag Polypropylene (PP)

Tömítő anyag NBR

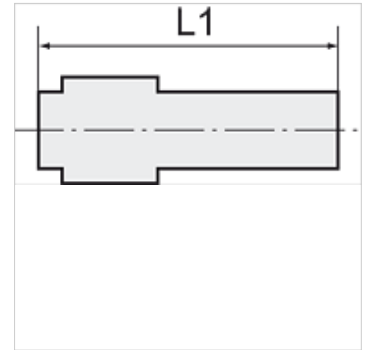

## Megjegyzés

További adatokért vegye fel a kapcsolatot.

## Leírás

Lightweight, push-in fittings distinguished by high strength, toughness, resistance to abrasion and impact resistance - ideal for a wide range of applications. Plastic and metal tubes are connected together quickly and easily. Suitable for compressed air or liquids, with good resistance to a large number of chemicals.

## Cikk

Megnevezés	tömlő külső Ø-höz	L1 (mm)	Csonkok (mm)
K- 07 40 29 00	22 mm	127,0	32
K- 07 40 29 01	28 mm	133,3	32