

K-W TUE VB PP

Union elbows

HANSA FLEX

Tulajdonságok

Munkanyomás on request

Üzemi hőmérséklet Max. +20 °C

Anyag Polypropylene (PP)

Tömítő anyag NBR

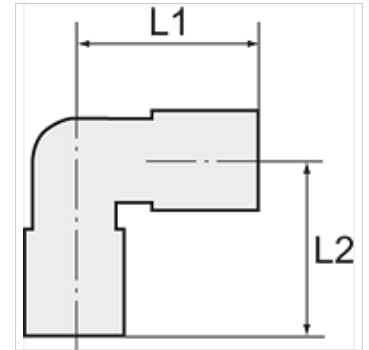

Megjegyzés

További adatokért vegye fel a kapcsolatot.

Leírás

Lightweight, push-in fittings distinguished by high strength, toughness, resistance to abrasion and impact resistance - ideal for a wide range of applications. Plastic and metal tubes are connected together quickly and easily. Suitable for compressed air or liquids, with good resistance to a large number of chemicals.

Cikk

Megnevezés	tömlő külső Ø-höz	L1 (mm)	L2 (mm)	Csonkok (mm)
K- 07 40 29 10	32 mm	105,3	96,0	32