

K-STECKVERSCH AGR OR SK M O

Male connectors, parallel male thread with O-ring and outer hex

HANSA FLEX

Tulajdonságok

| | |
|-------------------|-----------------------|
| Munkanyomás | Max. 16 bar |
| Üzemi hőmérséklet | -20 °C to +80 °C |
| Anyag | Sárgaréz, nikkelezett |
| Szorítógyűrű | Hostaform |
| O-gyűrű | NBR |
| Feszítőgyűrű | Stainless steel |

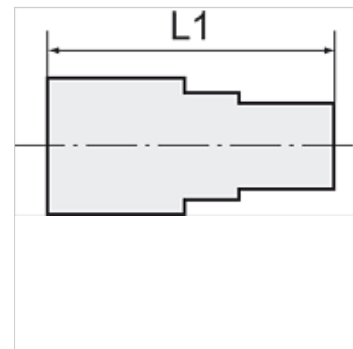

Megjegyzés

További adatokért vegye fel a kapcsolatot.

Leírás

The advanced version of our highly successful push-in fittings series manufactured in nickel-plated brass. Advantages of this new, optimised series: Much easier connection and disconnection of the hose, even with repeated mounting, can also be used for non-calibrated hoses, suitable for vacuum operation.

Cikk

| Megnevezés | Menet | tömlő külső Ø-höz | Belső kulcsnyílás (mm) | L1 (mm) | SW (Kulcsnyílás) |
|----------------|-------|-------------------|------------------------|---------|------------------|
| K- 07 40 24 82 | M 3 | 3 mm | 1,5 | 12,6 | Ø 5,8 mm |
| K- 07 40 24 83 | M 5 | 3 mm | 2,0 | 13,0 | Ø 5,8 mm |
| K- 07 40 24 84 | M 5 | 4 mm | 2,5 | 20,3 | Ø 9 mm |
| K- 07 40 24 85 | M 5 | 5 mm | 2,5 | 22,5 | Ø 12 mm |
| K- 07 40 24 86 | M 5 | 6 mm | 2,5 | 21,9 | Ø 11 mm |
| K- 07 40 24 87 | M 7 | 4 mm | 3,0 | 18,9 | Ø 9 mm |
| K- 07 40 24 88 | M 7 | 6 mm | 4,0 | 23,0 | Ø 11 mm |
| K- 07 40 24 98 | G 1/8 | 4 mm | 3,0 | 18,0 | 10 mm |
| K- 07 40 24 99 | G 1/8 | 5 mm | 3,0 | 22,0 | 13 mm |
| K- 07 40 25 00 | G 1/8 | 6 mm | 4,0 | 21,6 | 12 mm |
| K- 07 40 25 01 | G 1/8 | 8 mm | 5,0 | 25,4 | 13 mm |
| K- 07 40 24 94 | G 1/4 | 4 mm | 3,0 | 19,8 | 10 mm |
| K- 07 40 24 95 | G 1/4 | 5 mm | 3,0 | 24,0 | 12 mm |
| K- 07 40 24 96 | G 1/4 | 6 mm | 4,0 | 20,3 | 12 mm |
| K- 07 40 24 97 | G 1/4 | 8 mm | 6,0 | 24,4 | 14 mm |
| K- 07 40 24 92 | G 1/4 | 10 mm | 7,0 | 29,2 | 16 mm |
| K- 07 40 24 93 | G 1/4 | 12 mm | 7,0 | 30,5 | 19 mm |
| K- 07 40 25 05 | G 3/8 | 8 mm | 6,0 | 22,8 | 14 mm |
| K- 07 40 25 02 | G 3/8 | 10 mm | 8,0 | 26,5 | 16 mm |
| K- 07 40 25 03 | G 3/8 | 12 mm | 10,0 | 28,1 | 19 mm |
| K- 07 40 25 04 | G 3/8 | 14 mm | 10,0 | 33,8 | 22 mm |
| K- 07 40 24 89 | G 1/2 | 10 mm | 8,0 | 29,8 | 16 mm |
| K- 07 40 24 90 | G 1/2 | 12 mm | 10,0 | 29,3 | 19 mm |
| K- 07 40 24 91 | G 1/2 | 14 mm | 12,0 | 31,5 | 22 mm |