

K-STECKNIPPEL

push-in plug

HANSA FLEX

Tulajdonságok

Munkanyomás	Max. 16 bar
Üzemi hőmérséklet	-20 °C to +80 °C
Anyag	Sárgaréz, nikkelezett

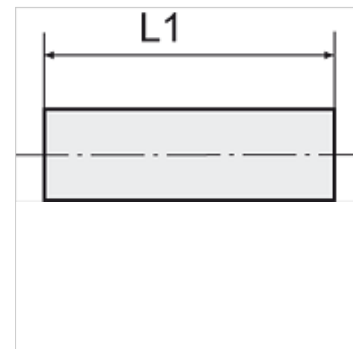
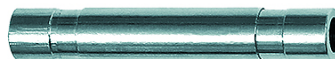

Megjegyzés

További adatokért vegye fel a kapcsolatot.

Leírás

The advanced version of our highly successful push-in fittings series manufactured in nickel-plated brass. Advantages of this new, optimised series: Much easier connection and disconnection of the hose, even with repeated mounting, can also be used for non-calibrated hoses, suitable for vacuum operation.

Cikk

Megnevezés	tömlő külső Ø-höz	L1 (mm)
K- 07 40 47 53	4 mm	34,0
K- 07 40 47 54	5 mm	34,0
K- 07 40 47 55	6 mm	37,5
K- 07 40 47 56	8 mm	37,5
K- 07 40 47 57	10 mm	45,0
K- 07 40 47 58	12 mm	48,0
K- 07 40 47 59	14 mm	58,0