

Caratteristiche

Attacco 1	Filetto esterno metrico cilindrico
Tenuta 1	Forma F
Attacco 2	Filetto esterno metrico cilindrico
Tenuta 2	Cono interno da 24°
Tipo	Raccordo orientabile a flusso libero
Forma costruttiva	Angolo di 90°
Norma	DIN 2353 ISO 8434-1
Entità della fornitura	Tronchetto con dado e anello di serraggio
Materiale	Acciaio
Protezione superficiale	con rivestimento elettrolitico

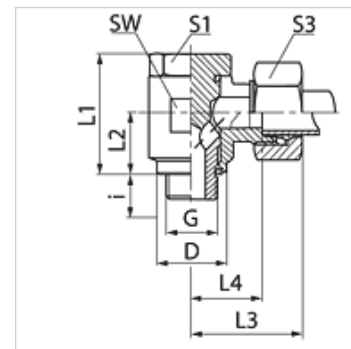

Nota

Le istruzioni per montaggio, installazione, pressioni e temperature d'esercizio ammesse possono essere desunte dalle informazioni tecniche per i raccordi filettati dei tubi.

Articolo

Denominazione	Serie	Pressione d'esercizio in bar:	diametro esterno del tubo Ø (mm)	G	D (mm)	i (mm)	L1 (mm)	L2 (mm)	L3 (mm)	L4 (mm)	SW (mm)	S1	S3	OR
SDOM 06 LL	LL	PN 100	6	M 10 x 1	14,7	8,0	23,5	10,5	28,0	13,5	17	17	12	7,65 x 1,78
SDOM 08 LL	LL	PN 100	8	M 10 x 1	14,7	8,0	23,5	10,5	28,0	13,5	17	17	14	7,65 x 1,78
SDOM NW 04 HL	L	PN 315	6	M 10 x 1	14,0	8,0	24,0	10,5	27,0	12,0	17	17	14	7,65 x 1,78
SDOM NW 06 HL	L	PN 315	8	M 12 x 1,5	17,0	12,0	30,0	14,0	29,0	14,5	22	19	17	11,10 x 1,78
SDOM NW 08 HL	L	PN 315	10	M 14 x 1,5	19,0	12,0	30,0	14,0	30,0	15,5	22	19	19	11,10 x 1,78
SDOM NW 10 HL	L	PN 315	12	M 16 x 1,5	21,0	12,0	36,0	16,5	33,0	18,0	27	24	22	14,00 x 1,78
SDOM NW 10 HL 18	L	PN 315	12	M 18 x 1,5	23,5	12,0	35,0	16,5	33,0	18,0	27	24	22	18,77 x 1,78
SDOM NW 13 HL	L	PN 315	15	M 18 x 1,5	23,0	12,0	39,5	18,5	37,0	21,5	30	27	27	18,77 x 1,78
SDOM NW 16 HL	L	PN 315	18	M 22 x 1,5	27,0	14,0	45,0	21,5	37,0	21,0	32	30	32	18,77 x 1,78
SDOM NW 20 HL	L	PN 160	22	M 26 x 1,5	31,0	16,0	53,0	24,0	44,0	27,5	41	36	36	23,81 x 2,62
SDOM NW 25 HL	L	PN 160	28	M 33 x 2	39,0	18,0	66,0	30,5	49,0	32,0	50	46	41	29,82 x 2,62
SDOM NW 32 HL	L	PN 160	35	M 42 x 2	49,0	20,0	76,0	35,5	58,0	36,0	60	55	50	37,77 x 2,62
SDOM NW 40 HL	L	PN 160	42	M 48 x 2	55,0	22,0	87,0	40,5	63,0	40,5	70	60	60	41,28 x 3,53
SDOM NW 03 HS	S	PN 400	6	M 12 x 1,5	17,0	12,0	30,0	14,0	31,0	16,5	22	19	17	11,10 x 1,78
SDOM NW 04 HS	S	PN 400	8	M 14 x 1,5	19,0	12,0	30,0	14,0	31,0	16,5	22	19	19	11,10 x 1,78
SDOM NW 06 HS	S	PN 400	10	M 16 x 1,5	21,0	12,0	35,0	16,5	35,0	18,5	27	24	22	14,00 x 1,78
SDOM NW 08 HS	S	PN 400	12	M 18 x 1,5	23,0	12,0	39,5	18,5	36,0	20,0	30	27	24	18,77 x 1,78
SDOM NW 10 HS	S	PN 400	14	M 20 x 1,5	25,0	14,0	43,5	20,0	40,0	22,5	32	30	27	18,77 x 1,78
SDOM NW 13 HS	S	PN 315	16	M 22 x 1,5	27,0	14,0	45,0	21,5	40,0	22,0	32	30	30	18,77 x 1,78
SDOM NW 16 HS	S	PN 315	20	M 27 x 2	32,0	16,0	53,0	24,0	48,0	26,5	41	36	36	23,81 x 2,62
SDOM NW 20 HS	S	PN 250	25	M 33 x 2	39,0	18,0	66,0	30,5	56,0	31,5	50	46	46	29,38 x 2,62
SDOM NW 25 HS	S	PN 160	30	M 42 x 2	49,0	20,0	76,0	35,5	64,0	37,0	60	55	50	37,77 x 2,62
SDOM NW 32 HS	S	PN 160	38	M 48 x 2	55,0	22,0	87,0	40,5	72,0	41,5	70	60	60	41,28 x 3,53

PN = pressione nominale PB = massima pressione d'esercizio - Serie: LL = molto leggero L = leggero S = pesante - Ø = diametro esterno tubo

Varianti dei prodotti

SDOM VA	Raccordo orientabile a flusso libero, W90°, Acciaio inossidabile
XSDOM	Raccordo orientabile a flusso libero, W90°, Acciaio