

Caratteristiche

| | |
|------------------------------|---|
| Tipo | Paraolio |
| Velocità di scorrimento max. | 0,8 m/s |
| Temperatura min. | -30 °C |
| Temperatura max. | 80 °C |
| Mezzi | Oli minerali |
| Montaggio | Sagomare a forma di rene il paraolio e premere per inserirlo nella scanalatura di alloggiamento |
| Esecuzione | Metrico |
| Materiale | PUR |
| Applicazione | Idraulica |

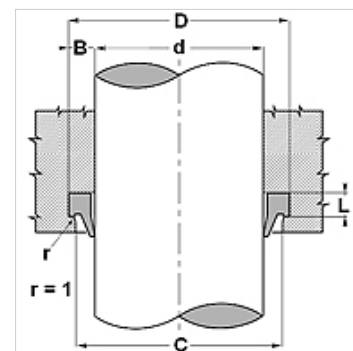

| Toleranz / Tolerance | | | |
|----------------------|------------|------------|------------|
| d | D | L | C |
| h11 | +0,20 0 | +0,10 0 | +0,20 0 |



Descrizione

semplice montaggio.
Soluzione semplice.
Considerevole resistenza all'abrasione.

Avvertenza per l'ordinazione

Si possono realizzare in tempi brevi paraolio con diametro da 20 a 510 mm.

Articolo

| Denominazione | d (mm) | D (mm) | L (mm) | C (mm) |
|---------------|-----------|-----------|-----------|-----------|
| WRM-P 04 | 4 | 12,0 | 3,0 | 9,0 |
| WRM-P 05-S | 5 | 12,0 | 2,8 | 9,0 |
| WRM-P 06-S | 6 | 12,0 | 3,0 | 9,0 |
| WRM-P 08 | 8 | 14,6 | 3,8 | 11,0 |
| WRM-P 10 | 10 | 16,6 | 3,8 | 13,0 |
| WRM-P 12 | 12 | 18,6 | 3,8 | 15,0 |
| WRM-P 14 | 14 | 20,6 | 3,8 | 17,0 |
| WRM-P 15 | 15 | 21,6 | 3,8 | 18,0 |
| WRM-P 16-1 | 16 | 22,5 | 3,0 | 19,0 |
| WRM-P 16 | 16 | 22,6 | 3,8 | 19,0 |
| WRM-P 18 | 18 | 24,6 | 3,8 | 21,0 |
| WRM-P 20-1 | 20 | 26,0 | 3,4 | 23,0 |
| WRM-P 20 | 20 | 28,6 | 5,3 | 23,0 |
| WRM-P 22 | 22 | 30,6 | 5,3 | 25,0 |
| WRM-P 25 | 25 | 33,6 | 5,3 | 28,0 |
| WRM-P 28 | 28 | 36,6 | 5,3 | 31,0 |
| WRM-P 30 | 30 | 38,6 | 5,3 | 33,0 |
| WRM-P 30-1 | 30 | 40,0 | 3,0 | 34,5 |
| WRM-P 32-1 | 32 | 40,0 | 3,7 | 35,0 |
| WRM-P 32 | 32 | 40,6 | 5,3 | 35,0 |
| WRM-P 35 | 35 | 43,6 | 5,3 | 38,0 |
| WRM-P 35-1B | 35 | 45,0 | 4,0 | 39,0 |
| WRM-P 36 | 36 | 44,6 | 5,3 | 39,0 |
| WRM-P 38 | 38 | 46,6 | 5,3 | 41,0 |
| WRM-P 38-1 | 38 | 48,5 | 4,8 | 41,0 |
| WRM-P 40 | 40 | 48,6 | 5,3 | 43,0 |
| WRM-P 42 | 42 | 50,6 | 5,3 | 45,0 |
| WRM-P 45 | 45 | 53,6 | 5,3 | 48,0 |
| WRM-P 45-1 | 45 | 55,6 | 5,3 | 48,0 |
| WRM-P 45-1B | 45 | 60,0 | 4,2 | 53,0 |
| WRM-P 50 | 50 | 58,6 | 5,3 | 53,0 |
| WRM-P 50-1 | 50 | 60,6 | 5,3 | 53,0 |
| WRM-P 50-1B | 50 | 65,5 | 4,2 | 58,0 |
| WRM-P 55 | 55 | 63,6 | 5,3 | 58,0 |
| WRM-P 55-1 | 55 | 65,6 | 5,3 | 58,0 |
| WRM-P 56 | 56 | 64,6 | 5,3 | 59,0 |
| WRM-P 56-1 | 56 | 66,6 | 5,3 | 59,0 |
| WRM-P 60 | 60 | 68,6 | 5,3 | 63,0 |



Articolo

| Denominazione | d (mm) | D (mm) | L (mm) | C (mm) |
|---------------|-----------|-----------|-----------|-----------|
| WRM-P 60-S | 60 | 70,6 | 5,5 | 66,5 |
| WRM-P 63 | 63 | 71,6 | 5,3 | 66,0 |
| WRM-P 63-1 | 63 | 73,6 | 5,3 | 67,0 |
| WRM-P 65 | 65 | 73,6 | 5,3 | 68,0 |
| WRM-P 65-2 | 65 | 75,6 | 5,3 | 69,0 |
| WRM-P 65-1 | 65 | 76,6 | 6,0 | 71,5 |
| WRM-P 70 | 70 | 78,6 | 5,3 | 73,0 |
| WRM-P 70-2 | 70 | 80,0 | 5,0 | 74,0 |
| WRM-P 70-1 | 70 | 82,6 | 7,1 | 76,0 |
| WRM-P 73-1 | 73 | 83,6 | 7,3 | 76,0 |
| WRM-P 75 | 75 | 83,6 | 5,3 | 78,0 |
| WRM-P 75-1 | 75 | 87,2 | 7,1 | 81,0 |
| WRM-P 78-2 | 78 | 86,0 | 5,0 | 81,0 |
| WRM-P 78-S | 78 | 88,6 | 5,5 | 84,5 |
| WRM-P 80 | 80 | 88,6 | 5,3 | 83,0 |
| WRM-P 80-1 | 80 | 92,6 | 7,1 | 86,0 |
| WRM-P 85-1 | 85 | 93,6 | 5,3 | 88,0 |
| WRM-P 85 | 85 | 97,2 | 7,1 | 91,0 |
| WRM-P 90 | 90 | 102,2 | 7,1 | 96,0 |
| WRM-P 92-S | 92 | 103,6 | 5,5 | 97,0 |
| WRM-P 95 | 95 | 107,2 | 7,1 | 101,0 |
| WRM-P 97-2 | 97 | 105,0 | 5,0 | 100,0 |
| WRM-P 99 | 99 | 109,6 | 5,5 | 103,0 |
| WRM-P 100 | 100 | 112,2 | 7,1 | 106,0 |
| WRM-P 105 | 105 | 117,2 | 7,1 | 111,0 |
| WRM-P 110 | 110 | 122,2 | 7,1 | 116,0 |
| WRM-P 115-1 | 115 | 123,6 | 5,3 | 118,0 |
| WRM-P 115 | 115 | 127,2 | 7,1 | 121,0 |
| WRM-P 120-S | 120 | 130,6 | 5,5 | 126,5 |
| WRM-P 120 | 120 | 132,2 | 7,1 | 126,0 |
| WRM-P 125 | 125 | 137,2 | 7,1 | 131,0 |
| WRM-P125-1 | 125 | 140,2 | 10,1 | 132,0 |
| WRM-P 130-1 | 130 | 138,6 | 5,3 | 133,0 |
| WRM-P 130 | 130 | 142,2 | 7,1 | 136,0 |
| WRM-P 135 | 135 | 147,2 | 7,1 | 141,0 |
| WRM-P 140-2 | 140 | 148,6 | 6,0 | 143,0 |
| WRM-P 140 | 140 | 152,2 | 7,1 | 146,0 |
| WRM-P 140-1 | 140 | 155,0 | 9,0 | 147,0 |
| WRM-P 141-S | 141 | 151,6 | 5,5 | 147,5 |
| WRM-P 145 | 145 | 157,2 | 7,1 | 151,0 |
| WRM-P 150-2 | 150 | 158,6 | 5,3 | 153,0 |
| WRM-P 150 | 150 | 162,2 | 7,1 | 156,0 |
| WRM-P 150-1 | 150 | 165,0 | 7,5 | 156,0 |
| WRM-P 150-3 | 150 | 165,2 | 10,1 | 158,0 |
| WRM-P 160-1 | 160 | 172,2 | 7,1 | 166,0 |
| WRM-P 160 | 160 | 175,2 | 10,1 | 167,6 |
| WRM-P 162-S | 162 | 172,6 | 5,5 | 168,0 |
| WRM-P 170 | 170 | 185,2 | 10,1 | 178,0 |
| WRM-P 180 | 180 | 195,2 | 10,1 | 188,0 |
| WRM-P 180-2 | 180 | 200,0 | 7,0 | 188,0 |
| WRM-P 180-3 | 180 | 200,0 | 10,2 | 190,0 |
| WRM-P 183-S | 183 | 193,6 | 5,5 | 189,0 |
| WRM-P 190-2 | 190 | 198,6 | 5,3 | 193,0 |
| WRM-P 190 | 190 | 205,2 | 10,1 | 198,0 |
| WRM-P 190-1 | 190 | 210,0 | 10,1 | 200,0 |
| WRM-P 200 | 200 | 215,2 | 10,1 | 208,0 |
| WRM-P 200-3 | 200 | 220,0 | 10,2 | 210,0 |
| WRM-P 220 | 220 | 235,2 | 10,1 | 228,0 |
| WRM-P 220-1 | 220 | 240,0 | 10,1 | 230,0 |
| WRM-P 230 | 230 | 245,2 | 10,1 | 238,0 |
| WRM-P 240 | 240 | 255,2 | 10,1 | 248,0 |
| WRM-P 300-5 | 300 | 315,2 | 10,1 | 308,0 |