

# K-DRUCKSCHALTER VAKUUM

Combined vacuum/pressure switch

**HANSA FLEX**

## Caratteristiche

<b>Tipo</b>	PNP
<b>Attacco fluido di misura</b>	G 1/8 male and M 5 female
<b>Isteresi</b>	Adjustable: 3 to 25% of set value
<b>Campo della temperatura:</b>	0 - 50 °C
<b>Mezzi</b>	Non-aggressive gases. dry, oil-free air
<b>Alloggiamento</b>	Polycarbonate
<b>Segnale d'uscita</b>	Analogue: 1 to 5 V
<b>Collegamento elettrico</b>	Male connector M8, four pin
<b>Capacità di commutazione</b>	125 mA
<b>Corrente assorbita</b>	30 mA
<b>Indicatore di stato</b>	LED

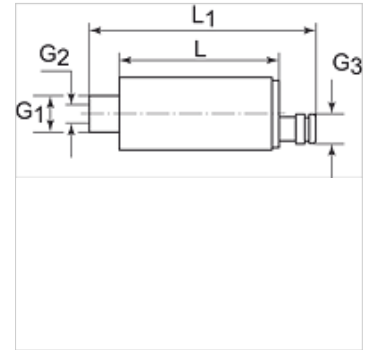
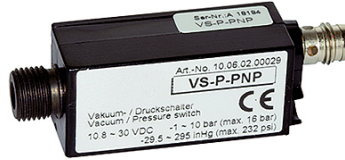

## Nota

Altri dati su richiesta.

## Descrizione

Universal electronic vacuum and pressure switch for safety monitoring, optimisation of cycle times and regulation circuits. Its small size and low weight permit installation directly at the point of use. <br>Suitable for all special applications in the vacuum and compressed air sectors. Adjustable vacuum limit value and continuous vacuum monitoring.

## Articolo

Denominazione	G1 esterno	G2 interno	G3 esterno	L (mm)	L1 (mm)	Campo di misurazione	Tensione
K- 07 45 01 31	G 1/8	M 5	M 8 x 1	44,0	62,0	-1 bis +10 bar	10.8 - 30 V DC