

# K-VAKUUMSENSOR ANALOG

Vacuum sensor, analogue

**HANSA FLEX**

## Caratteristiche

<b>Applicazione</b>	Measurement of vacuum values close to the suction pad Remote evaluation of the signals Processing the output signals, for example, by PLC
<b>Mezzi</b>	dry, oil-free air and non-aggressive gases
<b>Campo della temperatura:</b>	0 - 50 °C
<b>Segnale d'uscita</b>	1 to 5 analogous to V
<b>Isteresi</b>	Fixed: 20 mbar (model with digital sensor)
<b>Lunghezza cavo</b>	3 m
<b>Grado di protezione</b>	IP 40

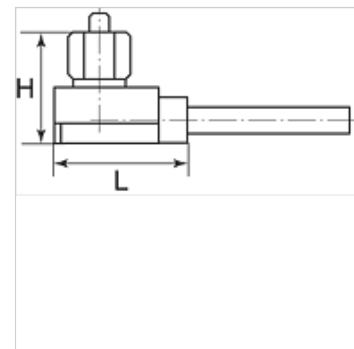

## Nota

Altri dati su richiesta.

## Descrizione

Mini-sensor with housing and connection cable, analogue or digital output signal. Minimum size and low weight combined with high measuring accuracy.

## Articolo

Denominazione	Attacco	H (mm)	L (mm)	Campo di misurazione	Tensione
K- 07 45 01 56	M 5 male	16,9	21,0	-1 bis 0 bar	10 - 24 V DC