

K-DRS ELK GERAETESTECKER

Pressure switches, connection with plug connector, type A acc. to DIN 43650

HANSA FLEX

Caratteristiche

Campo di impiego	Pneumatic applications
Frequenza di commutazione	200/min.
Tensione di commutazione	max. 250 V AC / 28 V DC
Grado di protezione	IP 65 (DIN 43650), IP 67 (M 12 x 1)
Campo della temperatura:	-10 °C to +80 °C
Calotta di regolazione	Aluminium, powder-coated
Alloggiamento	Special die-cast material
Membrana, guarnizione	NBR

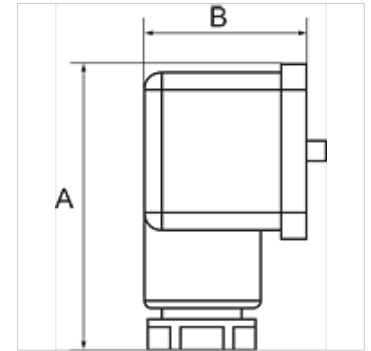

Nota

Altri dati su richiesta.

Descrizione

For converting pneumatic to electrical signals. Designed for use in rough vacuum applications (technical vacuum). Universal switch type, suitable as NC, NO or changeover contact. These devices are free from paint-wetting impairment substances (PWIS).

Articolo

Denominazione	Attacco	Intervallo di regolazione	A (mm)	B (mm)
K- 07 30 28 45	G 1/4	0,2 - 2,0 bar	48,0	28,0
K- 07 30 28 46	G 1/4	0,5 - 8,0 bar	48,0	28,0
K- 07 30 28 47	G 1/4	1,0 - 16,0 bar	48,0	28,0