

# K-BKR SERIE VALVE LINE

Stainless steel ball valves

**HANSA FLEX**

## Caratteristiche

<b>Pressione d'esercizio</b>	max. 70 bar, depending on temperature and nominal size
<b>Temperatura d'esercizio</b>	-15 °C to +110 °C, depending on port size and temperature
<b>Filettatura descrizione</b>	G thread acc. DIN EN ISO 228-1
<b>Guarnizione</b>	PTFE
<b>Leva manuale</b>	Stainless steel 1.4301
<b>Materiale</b>	sealing: PTFE

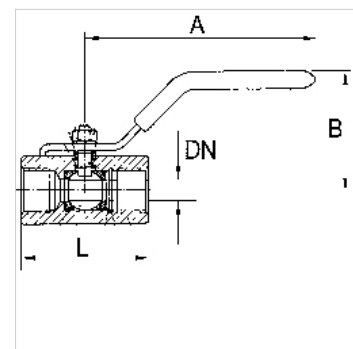

## Nota

Altri dati su richiesta.

## Articolo

Denominazione	DN	Filetto	A (mm)	B (mm)	L (mm)	Materiale
K- 07 30 15 24	13	1/4	99,5	47,0	47,5	Stainless steel 1.4408
K- 07 30 15 25	13	3/8	99,5	47,0	47,5	Stainless steel 1.4408
K- 07 30 15 26	15	1/2	99,5	48,0	58,0	Stainless steel 1.4408
K- 07 30 15 27	20	3/4	126,5	62,0	65,0	Stainless steel 1.4408
K- 07 30 15 28	25	1	126,5	69,0	77,0	Stainless steel 1.4408
K- 07 30 15 29	32	1 1/4	153,0	81,0	90,0	Stainless steel 1.4408
K- 07 30 15 30	38	1 1/2	153,0	87,0	98,5	Stainless steel 1.4408
K- 07 30 15 31	50	2	192,0	95,0	122,0	Stainless steel 1.4408