

# K-RD SCHRAEGSITZ VA

Unidirectional valves

**HANSA FLEX**

## Caratteristiche

Pressione d'esercizio	Max. 40 bar
Filettatura descrizione	G thread acc. DIN EN ISO 228-1
Temperatura del fluido	max. +180 °C
Pressione di apertura	min. 0.2 bar
Temperatura ambiente	Max. +180 °C
Alloggiamento, parti interne	Stainless Steel 1.4401/1.4408
Materiale di tenuta	FKM

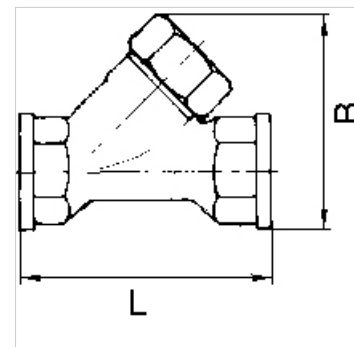
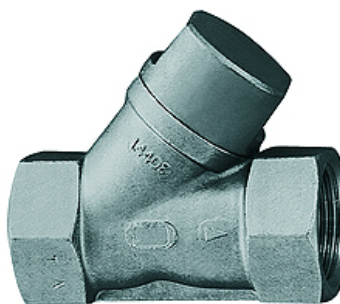

## Nota

Altri dati su richiesta.

## Articolo

Denominazione	Filetto	B (mm)	L (mm)	SW (mm)
K- 07 30 24 67	G 1/4	53,5	66,0	27
K- 07 30 24 68	G 3/8	53,5	66,0	27
K- 07 30 24 69	G 1/2	53,5	66,0	27
K- 07 30 24 70	G 3/4	68,0	76,0	32
K- 07 30 24 71	G 1	82,0	90,0	40
K- 07 30 24 72	G 1 1/4	97,0	110,0	50
K- 07 30 24 73	G 1 1/2	113,0	121,0	55
K- 07 30 24 74	G 2	131,0	151,0	70