

K-W90 STUECK IG AG RP-GEW

90° elbows, female-male, female thread: Rp thread acc. to ISO 7-1,
male thread: R thread acc. to ISO 7-1

HANSA FLEX

Caratteristiche

Pressione d'esercizio	max. 20 bar
Temperatura d'esercizio	Max. 175 °C
Filettatura interna	Rp-thread acc. ISO 7-1
Materiale	Stainless steel 1.4401 / 1.4408
Filettatura esterna	R-thread acc. ISO 7-1

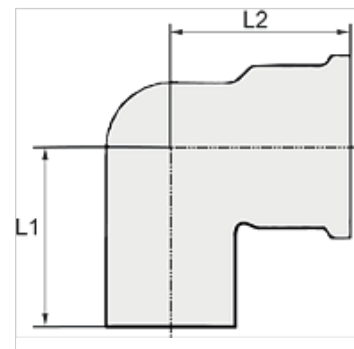

Nota

Altri dati su richiesta.

Articolo

Denominazione	Filetto	L1 (mm)	L2 (mm)
K- 07 40 10 33	Rp 1/8 female, R 1/8 male	24,0	17,0
K- 07 40 10 34	Rp 1/4 female, R 1/4 male	28,0	20,0
K- 07 40 10 35	Rp 3/8 female, R 3/8 male	32,0	22,0
K- 07 40 10 36	Rp 1/2 female, R 1/2 male	38,0	27,0
K- 07 40 10 37	Rp 3/4 female, R 3/4 male	45,0	32,0
K- 07 40 10 38	Rp 1 female, R 1 male	52,0	37,0