

K-MUFFEN RUND KURZ

Sockets, round, short type

HANSA FLEX

Caratteristiche

| | |
|---------------------|------------------------------|
| Pressione di lavoro | Max. 20 bar |
| Filettatura interna | Parallel to DIN EN ISO 228-1 |
| Materiale | Stainless steel 1.4408 |

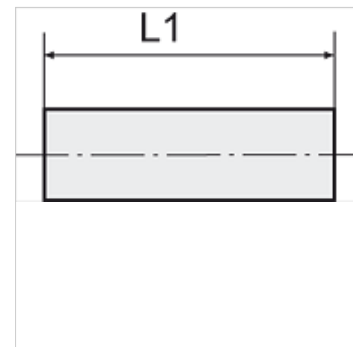

Nota

The dimensions of the standard screw fittings may change slightly during the life of the catalogue as a result of optimisation processes.
Altri dati su richiesta.

Articolo

| Denominazione | Filetto | L1 (mm) |
|----------------|---------|------------|
| K- 07 40 14 97 | G 1/8 | 7,2 |
| K- 07 40 14 98 | G 1/4 | 11,2 |
| K- 07 40 14 99 | G 3/8 | 11,8 |
| K- 07 40 15 00 | G 1/2 | 15,0 |
| K- 07 40 15 01 | G 3/4 | 16,0 |
| K- 07 40 15 02 | G 1 | 20,3 |
| K- 07 40 15 03 | G 1 1/4 | 22,4 |
| K- 07 40 15 04 | G 1 1/2 | 22,0 |
| K- 07 40 15 05 | G 2 | 26,0 |