

# K-W90 SCHLAUCH VB

Elbow hose connectors

**HANSA FLEX**

## Caratteristiche

|                              |   |
|------------------------------|---|
| <b>Pressione d'esercizio</b> | Dependent on operating temperature; Max. 10 bar (at 20 °C); Max. 1 bar (at 60 °C) |
| <b>Corpo di avvitamento</b>  | Polyamide (PA)  |
| <b>Anello di serraggio</b>   | Polypropylene (PP)  |
| <b>Dado</b>                  | Polypropylene (PP)  |

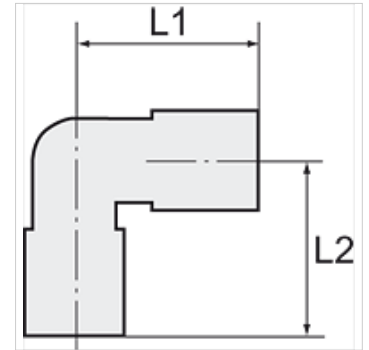

## Nota

Altri dati su richiesta.

## Descrizione

Manufactured from high impact-resistant, UV-stabilised engineering plastic, extremely resistant to weathering. Good chemical resistance to benzine, diesel oil, fuel oil and alkalis. <br>Not suitable for use with acids.

## Articolo

| Denominazione  | per flessibile | L1<br>(mm) | L2<br>(mm) |
|----------------|----------------|------------|------------|
| K- 07 40 32 66 | 4 mm / 6 mm    | 25,0       | 25,0       |
| K- 07 40 32 67 | 6 mm / 8 mm    | 30,0       | 30,0       |
| K- 07 40 32 68 | 8 mm / 10 mm   | 36,0       | 36,0       |
| K- 07 40 32 69 | 9 mm / 12 mm   | 43,0       | 43,0       |