

K-VERBINDER

Unions

HANSA FLEX

Caratteristiche

pressione d'esercizio max.	18 bar
tubi flessibili utilizzabili	PA, PE, PU
Materiale	Ottone nichelato

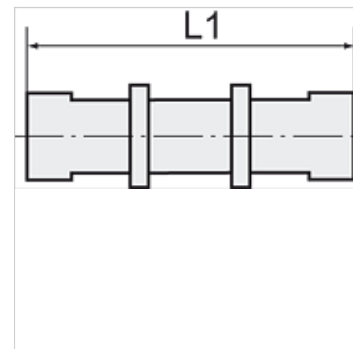
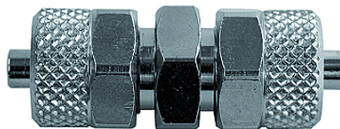

Nota

Altri dati su richiesta.

Articolo

Denominazione	per flessibile	L1 (mm)	SW
K- 07 40 33 69	5 mm / 3 mm	28,5	8 mm
K- 07 40 33 70	6 mm / 4 mm	34,5	12 mm
K- 07 40 33 71	8 mm / 6 mm	35,0	14 mm
K- 07 40 33 67	10 mm / 8 mm	38,0	14 mm
K- 07 40 33 68	12 mm / 10 mm	41,0	17 mm